

Newmark Homes

Freestanding  
Packages

Frigidaire®  
Built-In Packages

Electrolux  
Packages

Options

# Appliance Package Selections



NH100722

Building the Future, Together.

FRIGIDAIRE

FRIGIDAIRE  
GALLERY

FRIGIDAIRE  
PROFESSIONAL

 Electrolux

## Frigidaire® Stainless Standard

4540-F1 (Gas)

4540-F2 (Electric)

# FRIGIDAIRE



### 30" Gas Freestanding Range

FCRG3052AS

- 5 Sealed Gas Burners, including a 16,000 BTU Quick Boil Burner, 10,000 BTU Oval Burner, and a Low-Simmer Burner
- Continuous Corner-to-Corner Grates
- Easy cooktop cleanup with sealed gas burners
- Store-More™ Storage Drawer
- Even Baking Technology ensures that food comes out evenly



### 30" Electric Self-Cleaning Freestanding Range

FFEF3054TS

- Black Ceramic Glass Smoothtop Surface
- Elements: 6"/9" 1,400W / 3,000W, 12" 2,700W, (2) 6" 1,200W & Keep Warm Zone 100W
- 5.3 Cu.Ft Oven Capacity
- Bake 2,600W / Broil 3,000W
- Oven Racks: 2 Standard
- Storage Drawer



### 1.8 Cu. Ft. Over-The-Range Microwave

FMOS1846BS

- Convenient Quick Start Options
- Better cooktop visibility with LED lighting
- Two Speed Ventilation
- Filter Indicator Light



### 24" Built-In Tall Tub Dishwasher

FFCD2418US

- Quieter Decibel Level (dB): 55
- Fits up to 14 place settings
- Heated drying system
- 5 Wash Cycles
- 5 Wash Levels
- Grey Tub
- 4 Hour Delay Start

Frigidaire Gallery®  
Upgrade 1  
4540-F3 (Gas)  
4540-F4 (Electric)

FRIGIDAIRE  
GALLERY



**30" Freestanding Gas  
Range with Steam Clean**

GCRG3038AF

- Quick Bake Convection
- Fast Steam Cleaning Option
- Quick Boil Burner
- Continuous Corner-to-Corner Grates
- Low Simmer Burner
- Remote Control
- Bake 18,000 BTU / Broil 13,500 BTU
- Storage Drawer



**30" Freestanding Electric  
Range with Steam Clean**

GCRE3038AF

- SpaceWise® Expandable Elements
- Quick Bake Convection
- Quick Boil Element
- Fast Steam Cleaning Option
- One-Touch Self Clean
- SpaceWise® Warming Zone
- Even Baking Technology



**1.9 Cu. Ft. Over-The-  
Range Microwave**

GMOS1962AF

- Effortless™ Clean Interior helps wipe away spills easily
- Sensor Cooking automatically adjusts power levels and cooking times
- Powerful Three Speed Ventilation Fan



**24" Dishwasher**

GDPH4515AF

- Dual OrbitClean® Wash System
- MaxBoost™ Dry
- Fully-Integrated Controls
- 49 dBa
- SpaceWise® Adjustable Rack
- 34-Minute Quick Wash
- DishSense™ Technology
- 1 - 24 Hour Delay Start



## Frigidaire Gallery® Black Stainless Freestanding Package

FRIGIDAIRE  
GALLERY



### 30" Electric Freestanding Range with Air Fry

GCRE3060AD

- Make healthy and delicious meals with Air Fry
- Faster, more even baking with True Convection
- Quick Boil 3,000W Element
- SpaceWise® Triple Expandable Element
- Flexible Five Element Cooktop
- 30 Minute Fast Steam Clean Option



### 30" Gas Freestanding Range with Air Fry

GCRG3060AD

- Make healthy and delicious meals with Air Fry
- Faster, more even baking with True Convection
- Quick Boil Burner
- Fast Steam Cleaning Option
- Quick Preheat
- Flexible Five Burner Cooktop



### 1.9 Cu. Ft. Over-The- Range Microwave

FGBM19WNVD

- Effortless Clean™ Interior
- Cooktop LED Lighting
- Three Speed Ventilation Fan
- Sensor-Cook Options
- One-Touch Options
- Extra-Large 13-1/2" Diameter Glass Turntable
- Zero-Clearance Door

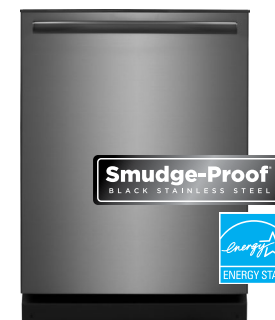

### 24" Dishwasher

GDPH4515AD

- Dual OrbitClean® Wash System
- MaxBoost™ Dry
- Fully-Integrated Controls
- 49 dBa
- SpaceWise® Adjustable Rack
- 34-Minute Quick Wash
- DishSense™ Technology
- 1 - 24 Hour Delay Start



## Frigidaire Professional® Professional Package 2

4540-GM (Gas)

4540-GN (Electric)

**FRIGIDAIRE**  
PROFESSIONAL.

**NEWMARK**  
HOMES



### 30" Front Control Gas Range with Air Fry

PCFG3078AF

- Make healthier and delicious meals with Air Fry
- Faster, more even baking results with True Convection
- Flexible Five Burner Cooktop
- Effortless™ Temperature Probe
- Fast Steam Cleaning Option
- ReadyCook™ Air Fry Tray Included
- Quick Boil Burner
- PowerPlus™ Quick Preheat
- Griddle Pan Included
- Continuous Corner-to-Corner Grates



### 30" Front Control Electric Range with Air Fry

PCFE3078AF

- Make healthier and delicious meals with Air Fry
- Faster, more even baking results with True Convection
- SpaceWise® Expandable Elements
- Effortless™ Temperature Probe
- Fast Steam Cleaning Option
- ReadyCook™ Air Fry Tray Included
- Quick Boil Element
- PowerPlus™ Quick Preheat
- SpacePro™ Bridge Element



### 1.8 Cu. Ft. Over-The-Range Convection Microwave

FPBM3077RF

- 1.8 Cu. Ft. Capacity / 1,050 Watts
- 14-3/16" Glass Turntable
- LED Lighting
- 10 Power Levels
- PowerPlus™ Convection
- 9 Auto-Cook Options
- Multi-Stage Cooking Options
- 6 PowerSense™ Cook Options
- 5 Auto-Reheat Options
- 3 Auto-Defrost Options
- PowerPlus™ 4-Speed Hidden Vent / 400 CFM



### 24" Built-In Dishwasher

FPID2498SF

- Fully-Integrated Pro-Select® Control Panel with Digital Display
- Quieter Decibel Level (dB): 47
- OrbitClean® Wash System
- 7 Wash Cycles / 5 Wash Levels
- Stainless Steel Tub
- SpaceWise® Adjustable Upper Rack
- 1 - 24 Hour Delay Start
- 30-Minute Quick Wash Cycle
- PowerBright™ Floor Light
- EvenDry™ System

## Frigidaire Gallery® Standard Package

4540-JA 1710-15

FRIGIDAIRE  
GALLERY



### 30" Single Electric Wall Oven with Total Convection

GCWS3067AF

- Our most advanced and powerful convection system, Total Convection gives you maximum versatility in the kitchen, powering cooking modes like Air Fry, No Preheat, Slow Cook, Convection Bake, Steam Bake, Convection Roast, Steam Roast, Air Sous Vide, Bread Proof, Dehydrate and more!
- Take the guesswork out of cooking with the Temperature Probe
- Premium Touch Screen Control Panel
- Better access to your meals with our Glide Rack



### 30" Gas Cooktop

GCCG3046AS

- Quick Boil 18,000 BTU burner
- Bright, backlit LED Knobs
- Low Simmer Burner
- Clean-up is less of a hassle with the recessed Spill Safe® cooktop that contains spills and common cooking messes
- Dishwasher safe burners caps
- Continuous edge-to-edge grates



### 30" Under-Cabinet Hood

FHWC3025MS

- 220 CFMs
- Rocker Switch Controls
- Fan Blower
- Vertical or Horizontal Air Discharge
- 2 Fan Speeds
- Incandescent Lighting
- Dishwasher-Safe Filters
- Convertible<sup>1</sup> Exhaust Duct

<sup>1</sup> Ventilation is convertible to be either ducted outside, or recirculated inside requiring no ducting. (Recirculated option requires use of a cover.)



### 2.2 Cu. Ft. Built-In Microwave with Trim Kit

GMBS3068AF/GMTK3068AF

- Extra-large microwave provides 2.2 cu. ft. of cooking space
- Sensor Cooking automatically adjusts power levels and cooking times to cook a variety of items, effortlessly
- Reheat leftovers easily with Sensor Reheat
- Interior LED lighting
- Get meals on the table in minutes with eight different Quick Start options that allow you to start cooking faster



### 24" Dishwasher

GDPH4515AF

- Dual OrbitClean® Wash System
- MaxBoost™ Dry
- Fully-Integrated Controls
- 49 dBA
- SpaceWise® Adjustable Rack
- 34-Minute Quick Wash
- DishSense™ Technology
- 1 - 24 Hour Delay Start

## Frigidaire Gallery® Double Oven Upgrade Package 4540-OA

FRIGIDAIRE  
GALLERY

**N**EWMARK  
HOMES



**30" Double Electric Wall  
Oven with Total Convection**  
GCWD3067AF

- Our most advanced and powerful convection system, Total Convection gives you maximum versatility in the kitchen, powering cooking modes like Air Fry, No Preheat, Slow Cook, Convection Bake, Steam Bake, Convection Roast, Steam Roast, Air Sous Vide, Bread Proof, Dehydrate and more!
- Take the guesswork out of cooking with the Temperature Probe
- Premium Touch Screen Control Panel
- Better access to your meals with our Glide Rack



**30" Gas Cooktop**  
GCCG3046AS

- Quick Boil 18,000 BTU burner
- Bright, backlit LED Knobs
- Low Simmer Burner
- Clean-up is less of a hassle with the recessed Spill Safe® cooktop that contains spills and common cooking messes
- Dishwasher safe burners caps
- Continuous edge-to-edge grates



**30" Under-Cabinet  
Hood**  
FHCW3025MS

- 220 CFMs
- Rocker Switch Controls
- Fan Blower
- Vertical or Horizontal Air Discharge
- 2 Fan Speeds
- Incandescent Lighting
- Dishwasher-Safe Filters
- Convertible<sup>1</sup> Exhaust Duct

<sup>1</sup> Ventilation is convertible to be either ducted outside, or recirculated inside requiring no ducting. (Recirculated option requires use of a cover)



**2.2 Cu. Ft. Built-In  
Microwave with  
Trim Kit**

GMBS3068AF/GMTK3068AF

- Extra-large microwave provides 2.2 cu. ft. of cooking space
- Sensor Cooking automatically adjusts power levels and cooking times to cook a variety of items, effortlessly
- Reheat leftovers easily with Sensor Reheat
- Interior LED lighting
- Get meals on the table in minutes with eight different Quick Start options that allow you to start cooking faster



**24" Dishwasher**  
GDPH4515AF

- Dual OrbitClean® Wash System
- MaxBoost™ Dry
- Fully-Integrated Controls
- 49 dBA
- SpaceWise® Adjustable Rack
- 34-Minute Quick Wash
- DishSense™ Technology
- 1 - 24 Hour Delay Start



## Frigidaire Gallery® Package 1

4540-HB 4540-M1

FRIGIDAIRE  
GALLERY



### 30" Single Electric Wall Oven with Total Convection

GCWS3067AF

- Our most advanced and powerful convection system, Total Convection gives you maximum versatility in the kitchen, powering cooking modes like Air Fry, No Preheat, Slow Cook, Convection Bake, Steam Bake, Convection Roast, Steam Roast, Air Sous Vide, Bread Proof, Dehydrate and more!
- Take the guesswork out of cooking with the Temperature Probe
- Premium Touch Screen Control Panel
- Better access to your meals with our Glide Rack



### 36" Gas Cooktop

GCCG3648AS

- Easy to use angled front controls
- Backlit knobs
- Continuous corner-to-corner cast iron grates
- Dishwasher safe
- 5 burners - 12,000 BTU, (2) 9,500 BTU, 7,500 BTU, 18,000 BTU



### 36" Under-Cabinet Hood

FHWC3625MS

- 220 CFMs
- Rocker Switch Controls
- Fan Blower
- Vertical or Horizontal Air Discharge
- 2 Fan Speeds
- Incandescent Lighting
- Dishwasher-Safe Filters
- Convertible<sup>1</sup> Exhaust Duct

<sup>1</sup> Ventilation is convertible to be either ducted outside, or recirculated inside requiring no ducting. (Recirculated option requires use of a cover.)



### 2.2 Cu. Ft. Built-In Microwave with Trim Kit

GMBS3068AF/GMTK3068AF

- Extra-large microwave provides 2.2 cu. ft. of cooking space
- Sensor Cooking automatically adjusts power levels and cooking times to cook a variety of items, effortlessly
- Reheat leftovers easily with Sensor Reheat
- Interior LED lighting
- Get meals on the table in minutes with eight different Quick Start options that allow you to start cooking faster



### 24" Dishwasher

GDPH4515AF

- Dual OrbitClean® Wash System
- MaxBoost™ Dry
- Fully-Integrated Controls
- 49 dBA
- SpaceWise® Adjustable Rack
- 34-Minute Quick Wash
- DishSense™ Technology
- 1 - 24 Hour Delay Start

## Frigidaire Gallery® Package 2

4540-HC 4540-M2

FRIGIDAIRE  
GALLERY



### 30" Single Electric Wall Oven with Total Convection

GCWS3067AF

- Our most advanced and powerful convection system, Total Convection gives you maximum versatility in the kitchen, powering cooking modes like Air Fry, No Preheat, Slow Cook, Convection Bake, Steam Bake, Convection Roast, Steam Roast, Air Sous Vide, Bread Proof, Dehydrate and more!
- Take the guesswork out of cooking with the Temperature Probe
- Premium Touch Screen Control Panel
- Better access to your meals with our Glide Rack



### 36" Gas Cooktop

GCCG3648AS

- Easy to use angled front controls
- Backlit knobs
- Continuous corner-to-corner cast iron grates
- Dishwasher safe
- 5 burners - 12,000 BTU, (2) 9,500 BTU, 7,500 BTU, 18,000 BTU



### 42" Wooden Timberlake Hood



### 2.2 Cu. Ft. Built-In Microwave with Trim Kit

GMBS3068AF/GMTK3068AF

- Extra-large microwave provides 2.2 cu. ft. of cooking space
- Sensor Cooking automatically adjusts power levels and cooking times to cook a variety of items, effortlessly
- Reheat leftovers easily with Sensor Reheat
- Interior LED lighting
- Get meals on the table in minutes with eight different Quick Start options that allow you to start cooking faster



### 24" Dishwasher

GDPH4515AF

- Dual OrbitClean® Wash System
- MaxBoost™ Dry
- Fully-Integrated Controls
- 49 dBA
- SpaceWise® Adjustable Rack
- 34-Minute Quick Wash
- DishSense™ Technology
- 1 - 24 Hour Delay Start

## Frigidaire Gallery® Package 4

4540-TA 4540-TM

FRIGIDAIRE  
GALLERY



### 30" Single Electric Wall Oven with Total Convection

GCWS3067AF

- Our most advanced and powerful convection system, Total Convection gives you maximum versatility in the kitchen, powering cooking modes like Air Fry, No Preheat, Slow Cook, Convection Bake, Steam Bake, Convection Roast, Steam Roast, Air Sous Vide, Bread Proof, Dehydrate and more!
- Take the guesswork out of cooking with the Temperature Probe
- Premium Touch Screen Control Panel
- Better access to your meals with our Glide Rack



### 36" Gas Cooktop

GCCG3648AS

- Easy to use angled front controls
- Backlit knobs
- Continuous corner-to-corner cast iron grates
- Dishwasher safe
- 5 burners - 12,000 BTU, (2) 9,500 BTU, 7,500 BTU, 18,000 BTU



### 42" Wooden Shiplap Hood



### 2.2 Cu. Ft. Built-In Microwave with Trim Kit

GMBS3068AF/GMTK3068AF

- Extra-large microwave provides 2.2 cu. ft. of cooking space
- Sensor Cooking automatically adjusts power levels and cooking times to cook a variety of items, effortlessly
- Reheat leftovers easily with Sensor Reheat
- Interior LED lighting
- Get meals on the table in minutes with eight different Quick Start options that allow you to start cooking faster



### 24" Dishwasher

GDPH4515AF

- Dual OrbitClean® Wash System
- MaxBoost™ Dry
- Fully-Integrated Controls
- 49 dBA
- SpaceWise® Adjustable Rack
- 34-Minute Quick Wash
- DishSense™ Technology
- 1 - 24 Hour Delay Start



## Frigidaire Gallery® Package 3

4540-HD 4540-P1

FRIGIDAIRE  
GALLERY



### 30" Single Electric Wall Oven with Total Convection

GCWS3067AF

- Our most advanced and powerful convection system, Total Convection gives you maximum versatility in the kitchen, powering cooking modes like Air Fry, No Preheat, Slow Cook, Convection Bake, Steam Bake, Convection Roast, Steam Roast, Air Sous Vide, Bread Proof, Dehydrate and more!
- Take the guesswork out of cooking with the Temperature Probe
- Premium Touch Screen Control Panel
- Better access to your meals with our Glide Rack



### 36" Gas Cooktop

GCCG3648AS

- Easy to use angled front controls
- Backlit knobs
- Continuous corner-to-corner cast iron grates
- Dishwasher safe
- 5 burners – 12,000 BTU, (2) 9,500 BTU, 7,500 BTU, 18,000 BTU

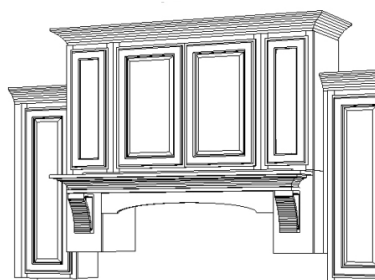

### 62" Wooden Shaker Style Hood



### 2.2 Cu. Ft. Built-In Microwave with Trim Kit

GMBS3068AF/GMTK3068AF

- Extra-large microwave provides 2.2 cu. ft. of cooking space
- Sensor Cooking automatically adjusts power levels and cooking times to cook a variety of items, effortlessly
- Reheat leftovers easily with Sensor Reheat
- Interior LED lighting
- Get meals on the table in minutes with eight different Quick Start options that allow you to start cooking faster



### 24" Dishwasher

GDPH4515AF

- Dual OrbitClean® Wash System
- MaxBoost™ Dry
- Fully-Integrated Controls
- 49 dBA
- SpaceWise® Adjustable Rack
- 34-Minute Quick Wash
- DishSense™ Technology
- 1 - 24 Hour Delay Start

## Frigidaire Gallery® Double Oven Package 1

4540-JB 4540-N5

FRIGIDAIRE  
GALLERY



**30" Double Electric Wall  
Oven with Total Convection**  
GCWD3067AF

- Our most advanced and powerful convection system, Total Convection gives you maximum versatility in the kitchen, powering cooking modes like Air Fry, No Preheat, Slow Cook, Convection Bake, Steam Bake, Convection Roast, Steam Roast, Air Sous Vide, Bread Proof, Dehydrate and more!
- Take the guesswork out of cooking with the Temperature Probe
- Premium Touch Screen Control Panel
- Better access to your meals with our Glide Rack



**36" Gas Cooktop**  
GCCG3648AS

- Easy to use angled front controls
- Backlit knobs
- Continuous corner-to-corner cast iron grates
- Dishwasher safe
- 5 burners - 12,000 BTU, (2) 9,500 BTU, 7,500 BTU, 18,000 BTU



**36" Under-Cabinet  
Hood**  
FHWC3625MS

- 220 CFMs
- Rocker Switch Controls
- Fan Blower
- Vertical or Horizontal Air Discharge
- 2 Fan Speeds
- Incandescent Lighting
- Dishwasher-Safe Filters
- Convertible<sup>1</sup> Exhaust Duct

<sup>1</sup> Ventilation is convertible to be either ducted outside, or recirculated inside requiring no ducting. (Recirculated option requires use of a cover.)



**2.2 Cu. Ft. Built-In  
Microwave with  
Trim Kit**

GMBS3068AF/GMTK3068AF

- Extra-large microwave provides 2.2 cu. ft. of cooking space
- Sensor Cooking automatically adjusts power levels and cooking times to cook a variety of items, effortlessly
- Reheat leftovers easily with Sensor Reheat
- Interior LED lighting
- Get meals on the table in minutes with eight different Quick Start options that allow you to start cooking faster



**24" Dishwasher**  
GDPH4515AF

- Dual OrbitClean® Wash System
- MaxBoost™ Dry
- Fully-Integrated Controls
- 49 dBA
- SpaceWise® Adjustable Rack
- 34-Minute Quick Wash
- DishSense™ Technology
- 1 - 24 Hour Delay Start

## Frigidaire Gallery® Double Oven Package 2

4540-JC 4540-N6

FRIGIDAIRE  
GALLERY



**30" Double Electric Wall  
Oven with Total Convection**  
GCWD3067AF

- Our most advanced and powerful convection system, Total Convection gives you maximum versatility in the kitchen, powering cooking modes like Air Fry, No Preheat, Slow Cook, Convection Bake, Steam Bake, Convection Roast, Steam Roast, Air Sous Vide, Bread Proof, Dehydrate and more!
- Take the guesswork out of cooking with the Temperature Probe
- Premium Touch Screen Control Panel
- Better access to your meals with our Glide Rack



**36" Gas Cooktop**  
GCCG3648AS

- Easy to use angled front controls
- Backlit knobs
- Continuous corner-to-corner cast iron grates
- Dishwasher safe
- 5 burners – 12,000 BTU, (2) 9,500 BTU, 7,500 BTU, 18,000 BTU



**42" Wooden  
Timberlake Hood**



**2.2 Cu. Ft. Built-In  
Microwave with  
Trim Kit**

GMBS3068AF/GMTK3068AF

- Extra-large microwave provides 2.2 cu. ft. of cooking space
- Sensor Cooking automatically adjusts power levels and cooking times to cook a variety of items, effortlessly
- Reheat leftovers easily with Sensor Reheat
- Interior LED lighting
- Get meals on the table in minutes with eight different Quick Start options that allow you to start cooking faster

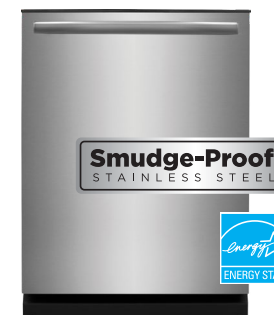

**24" Dishwasher**  
GDPH4515AF

- Dual OrbitClean® Wash System
- MaxBoost™ Dry
- Fully-Integrated Controls
- 49 dBA
- SpaceWise® Adjustable Rack
- 34-Minute Quick Wash
- DishSense™ Technology
- 1 - 24 Hour Delay Start



## Frigidaire Gallery® Double Oven Package 4

4540-TB 4540-TN

FRIGIDAIRE  
GALLERY



### 30" Double Electric Wall Oven with Total Convection

GCWD3067AF

- Our most advanced and powerful convection system, Total Convection gives you maximum versatility in the kitchen, powering cooking modes like Air Fry, No Preheat, Slow Cook, Convection Bake, Steam Bake, Convection Roast, Steam Roast, Air Sous Vide, Bread Proof, Dehydrate and more!
- Take the guesswork out of cooking with the Temperature Probe
- Premium Touch Screen Control Panel
- Better access to your meals with our Glide Rack



### 36" Gas Cooktop

GCCG3648AS

- Easy to use angled front controls
- Backlit knobs
- Continuous corner-to-corner cast iron grates
- Dishwasher safe
- 5 burners – 12,000 BTU, (2) 9,500 BTU, 7,500 BTU, 18,000 BTU



### 42" Wooden Shiplap Hood



### 2.2 Cu. Ft. Built-In Microwave with Trim Kit

GMBS3068AF/GMTK3068AF

- Extra-large microwave provides 2.2 cu. ft. of cooking space
- Sensor Cooking automatically adjusts power levels and cooking times to cook a variety of items, effortlessly
- Reheat leftovers easily with Sensor Reheat
- Interior LED lighting
- Get meals on the table in minutes with eight different Quick Start options that allow you to start cooking faster



### 24" Dishwasher

GDPH4515AF

- Dual OrbitClean® Wash System
- MaxBoost™ Dry
- Fully-Integrated Controls
- 49 dBA
- SpaceWise® Adjustable Rack
- 34-Minute Quick Wash
- DishSense™ Technology
- 1 - 24 Hour Delay Start

## Frigidaire Gallery® Double Oven Package 3

4540-JD 4540-P2

FRIGIDAIRE  
GALLERY



### 30" Double Electric Wall Oven with Total Convection

GCWD3067AF

- Our most advanced and powerful convection system, Total Convection gives you maximum versatility in the kitchen, powering cooking modes like Air Fry, No Preheat, Slow Cook, Convection Bake, Steam Bake, Convection Roast, Steam Roast, Air Sous Vide, Bread Proof, Dehydrate and more!
- Take the guesswork out of cooking with the Temperature Probe
- Premium Touch Screen Control Panel
- Better access to your meals with our Glide Rack



### 36" Gas Cooktop

GCCG3648AS

- Easy to use angled front controls
- Backlit knobs
- Continuous corner-to-corner cast iron grates
- Dishwasher safe
- 5 burners - 12,000 BTU, (2) 9,500 BTU, 7,500 BTU, 18,000 BTU

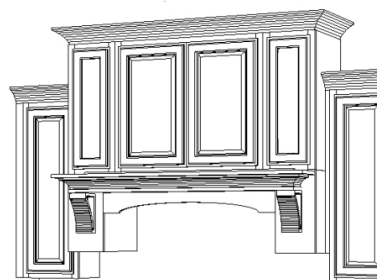

### 62" Wooden Shaker Style Hood



### 2.2 Cu. Ft. Built-In Microwave with Trim Kit

GMBS3068AF/GMTK3068AF

- Extra-large microwave provides 2.2 cu. ft. of cooking space
- Sensor Cooking automatically adjusts power levels and cooking times to cook a variety of items, effortlessly
- Reheat leftovers easily with Sensor Reheat
- Interior LED lighting
- Get meals on the table in minutes with eight different Quick Start options that allow you to start cooking faster



### 24" Dishwasher

GDPH4515AF

- Dual OrbitClean® Wash System
- MaxBoost™ Dry
- Fully-Integrated Controls
- 49 dBa
- SpaceWise® Adjustable Rack
- 34-Minute Quick Wash
- DishSense™ Technology
- 1 - 24 Hour Delay Start

## Frigidaire Gallery® Black Stainless Package 1

4540-HE 4540-MG

FRIGIDAIRE  
GALLERY



### 30" Single Electric Wall Oven with Total Convection

GCWS3067AD

- Our most advanced and powerful convection system, Total Convection gives you maximum versatility in the kitchen, powering cooking modes like Air Fry, No Preheat, Slow Cook, Convection Bake, Steam Bake, Convection Roast, Steam Roast, Air Sous Vide, Bread Proof, Dehydrate and more!
- Take the guesswork out of cooking with the Temperature Probe
- Premium Touch Screen Control Panel
- Better access to your meals with our Glide Rack



### 30" Gas Cooktop

GCCG3048AB

- Stainless Steel Recessed Cooktop
- 5 Sealed Burners: 18,000 BTU, 12,000 BTU, 9,500 BTU, 7,500 BTU & 5,000 BTU
- Express-Select® Controls
- Continuous Corner-To-Corner Grates
- Low Simmer Burner
- Electronic Pilotless Ignition



### 30" Under-Cabinet Hood

FHWC3025MB

- 220 CFMs
- Rocker Switch Controls
- Fan Blower
- Vertical or Horizontal Air Discharge
- 2 Fan Speeds
- Incandescent Lighting
- Dishwasher-Safe Filters
- Convertible<sup>1</sup> Exhaust Duct

<sup>1</sup>Ventilation is convertible to be either ducted outside, or recirculated inside requiring no ducting. (Recirculated option requires use of a cover.)



### 2.2 Cu. Ft. Built-In Microwave with Trim Kit

GMBS3068AD/GMTK3068AD

- Extra-large microwave provides 2.2 cu. ft. of cooking space
- Sensor Cooking automatically adjusts power levels and cooking times to cook a variety of items, effortlessly
- Reheat leftovers easily with Sensor Reheat
- Interior LED lighting
- Get meals on the table in minutes with eight different Quick Start options that allow you to start cooking faster



### 24" Dishwasher

GDPH4515AD

- Dual OrbitClean® Wash System
- MaxBoost™ Dry
- Fully-Integrated Controls
- 49 dBA
- SpaceWise® Adjustable Rack
- 34-Minute Quick Wash
- DishSense™ Technology
- 1 - 24 Hour Delay Start

Building the Future, Together.

FRIGIDAIRE

FRIGIDAIRE  
GALLERY

FRIGIDAIRE  
PROFESSIONAL

Electrolux

## Frigidaire Gallery® Black Stainless Package 2

4540-HG 4540-MI

FRIGIDAIRE  
GALLERY



### 30" Single Electric Wall Oven with Total Convection

GCWS3067AD

- Our most advanced and powerful convection system, Total Convection gives you maximum versatility in the kitchen, powering cooking modes like Air Fry, No Preheat, Slow Cook, Convection Bake, Steam Bake, Convection Roast, Steam Roast, Air Sous Vide, Bread Proof, Dehydrate and more!
- Take the guesswork out of cooking with the Temperature Probe
- Premium Touch Screen Control Panel
- Better access to your meals with our Glide Rack



### 36" Gas Cooktop

GCCG3648AB

- Easy to use angled front controls
- Backlit knobs
- Continuous corner-to-corner cast iron grates
- Dishwasher safe
- 5 burners - 12,000 BTU, (2) 9,500 BTU, 7,500 BTU, 18,000 BTU



### 42" Wooden Timberlake Hood



### 2.2 Cu. Ft. Built-In Microwave with Trim Kit

GMBS3068AD/GMTK3068AD

- Extra-large microwave provides 2.2 cu. ft. of cooking space
- Sensor Cooking automatically adjusts power levels and cooking times to cook a variety of items, effortlessly
- Reheat leftovers easily with Sensor Reheat
- Interior LED lighting
- Get meals on the table in minutes with eight different Quick Start options that allow you to start cooking faster



### 24" Dishwasher

GDPH4515AD

- Dual OrbitClean® Wash System
- MaxBoost™ Dry
- Fully-Integrated Controls
- 49 dBA
- SpaceWise® Adjustable Rack
- 34-Minute Quick Wash
- DishSense™ Technology
- 1 - 24 Hour Delay Start

Building the Future, Together.

FRIGIDAIRE

FRIGIDAIRE  
GALLERY

FRIGIDAIRE  
PROFESSIONAL

Electrolux

## Frigidaire Gallery® Black Stainless Package 4

4540-TC 4540-TO

FRIGIDAIRE  
GALLERY



### 30" Single Electric Wall Oven with Total Convection

GCWS3067AD

- Our most advanced and powerful convection system, Total Convection gives you maximum versatility in the kitchen, powering cooking modes like Air Fry, No Preheat, Slow Cook, Convection Bake, Steam Bake, Convection Roast, Steam Roast, Air Sous Vide, Bread Proof, Dehydrate and more!
- Take the guesswork out of cooking with the Temperature Probe
- Premium Touch Screen Control Panel
- Better access to your meals with our Glide Rack



### 36" Gas Cooktop

GCCG3648AB

- Easy to use angled front controls
- Backlit knobs
- Continuous corner-to-corner cast iron grates
- Dishwasher safe
- 5 burners - 12,000 BTU, (2) 9,500 BTU, 7,500 BTU, 18,000 BTU



### 42" Wooden Shiplap Hood



### 2.2 Cu. Ft. Built-In Microwave with Trim Kit

GMBS3068AD/GMTK3068AD

- Extra-large microwave provides 2.2 cu. ft. of cooking space
- Sensor Cooking automatically adjusts power levels and cooking times to cook a variety of items, effortlessly
- Reheat leftovers easily with Sensor Reheat
- Interior LED lighting
- Get meals on the table in minutes with eight different Quick Start options that allow you to start cooking faster



### 24" Dishwasher

GDPH4515AD

- Dual OrbitClean® Wash System
- MaxBoost™ Dry
- Fully-Integrated Controls
- 49 dBA
- SpaceWise® Adjustable Rack
- 34-Minute Quick Wash
- DishSense™ Technology
- 1 - 24 Hour Delay Start



## Frigidaire Gallery® Black Stainless Package 3

4540-HH 4540-MJ

FRIGIDAIRE  
GALLERY



### 30" Single Electric Wall Oven with Total Convection

GCWS3067AD

- Our most advanced and powerful convection system, Total Convection gives you maximum versatility in the kitchen, powering cooking modes like Air Fry, No Preheat, Slow Cook, Convection Bake, Steam Bake, Convection Roast, Steam Roast, Air Sous Vide, Bread Proof, Dehydrate and more!
- Take the guesswork out of cooking with the Temperature Probe
- Premium Touch Screen Control Panel
- Better access to your meals with our Glide Rack



### 36" Gas Cooktop

GCCG3648AB

- Easy to use angled front controls
- Backlit knobs
- Continuous corner-to-corner cast iron grates
- Dishwasher safe
- 5 burners – 12,000 BTU, (2) 9,500 BTU, 7,500 BTU, 18,000 BTU

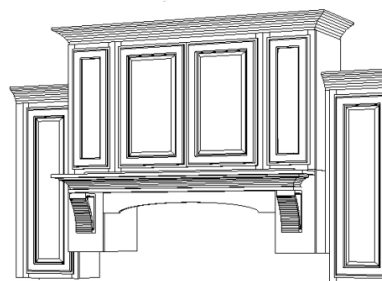

### 62" Wooden Shaker Style Hood



### 2.2 Cu. Ft. Built-In Microwave with Trim Kit

GMBS3068AD/GMTK3068AD

- Extra-large microwave provides 2.2 cu. ft. of cooking space
- Sensor Cooking automatically adjusts power levels and cooking times to cook a variety of items, effortlessly
- Reheat leftovers easily with Sensor Reheat
- Interior LED lighting
- Get meals on the table in minutes with eight different Quick Start options that allow you to start cooking faster



### 24" Dishwasher

GDPH4515AD

- Dual OrbitClean® Wash System
- MaxBoost™ Dry
- Fully-Integrated Controls
- 49 dBA
- SpaceWise® Adjustable Rack
- 34-Minute Quick Wash
- DishSense™ Technology
- 1 - 24 Hour Delay Start

# Frigidaire Gallery® Black Stainless Double Oven Package 1

4540-HI 4540-MN

FRIGIDAIRE  
GALLERY



## 30" Double Electric Wall Oven with Total Convection

GCWD3067AD

- Our most advanced and powerful convection system, Total Convection gives you maximum versatility in the kitchen, powering cooking modes like Air Fry, No Preheat, Slow Cook, Convection Bake, Steam Bake, Convection Roast, Steam Roast, Air Sous Vide, Bread Proof, Dehydrate and more!
- Take the guesswork out of cooking with the Temperature Probe
- Premium Touch Screen Control Panel
- Better access to your meals with our Glide Rack



## 30" Gas Cooktop

GCCG3048AB

- Stainless Steel Recessed Cooktop
- 5 Sealed Burners: 18,000 BTU, 12,000 BTU, 9,500 BTU, 7,500 BTU & 5,000 BTU
- Express-Select® Controls
- Continuous Corner-To-Corner Grates
- Low Simmer Burner
- Electronic Pilotless Ignition



## 30" Under-Cabinet Hood

FHWC3025MB

- 220 CFMs
- Rocker Switch Controls
- Fan Blower
- Vertical or Horizontal Air Discharge
- 2 Fan Speeds
- Incandescent Lighting
- Dishwasher-Safe Filters
- Convertible<sup>1</sup> Exhaust Duct

<sup>1</sup> Ventilation is convertible to be either ducted outside, or recirculated inside requiring no ducting. (Recirculated option requires use of a cover.)



## 2.2 Cu. Ft. Built-In Microwave with Trim Kit

GMBS3068AD/GMTK3068AD

- Extra-large microwave provides 2.2 cu. ft. of cooking space
- Sensor Cooking automatically adjusts power levels and cooking times to cook a variety of items, effortlessly
- Reheat leftovers easily with Sensor Reheat
- Interior LED lighting
- Get meals on the table in minutes with eight different Quick Start options that allow you to start cooking faster

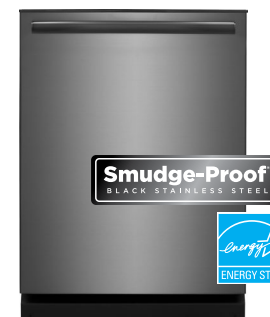

## 24" Dishwasher

GDPH4515AD

- Dual OrbitClean® Wash System
- MaxBoost™ Dry
- Fully-Integrated Controls
- 49 dBA
- SpaceWise® Adjustable Rack
- 34-Minute Quick Wash
- DishSense™ Technology
- 1 - 24 Hour Delay Start

Building the Future, Together.

FRIGIDAIRE

FRIGIDAIRE  
GALLERY

FRIGIDAIRE  
PROFESSIONAL

Electrolux

# Frigidaire Gallery® Black Stainless Double Oven Package 2

4540-HK 4540-MP

FRIGIDAIRE  
GALLERY

**N**EWMARK  
HOMES



## 30" Double Electric Wall Oven with Total Convection

GCWD3067AD

- Our most advanced and powerful convection system, Total Convection gives you maximum versatility in the kitchen, powering cooking modes like Air Fry, No Preheat, Slow Cook, Convection Bake, Steam Bake, Convection Roast, Steam Roast, Air Sous Vide, Bread Proof, Dehydrate and more!
- Take the guesswork out of cooking with the Temperature Probe
- Premium Touch Screen Control Panel
- Better access to your meals with our Glide Rack



## 36" Gas Cooktop

GCCG3648AB

- Easy to use angled front controls
- Backlit knobs
- Continuous corner-to-corner cast iron grates
- Dishwasher safe
- 5 burners - 12,000 BTU, (2) 9,500 BTU, 7,500 BTU, 18,000 BTU



## 42" Wooden Timberlake Hood



## 2.2 Cu. Ft. Built-In Microwave with Trim Kit

GMBS3068AD/GMTK3068AD

- Extra-large microwave provides 2.2 cu. ft. of cooking space
- Sensor Cooking automatically adjusts power levels and cooking times to cook a variety of items, effortlessly
- Reheat leftovers easily with Sensor Reheat
- Interior LED lighting
- Get meals on the table in minutes with eight different Quick Start options that allow you to start cooking faster

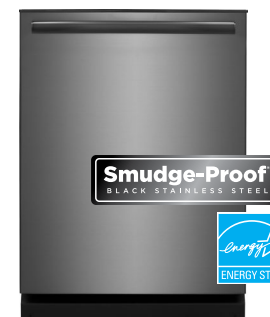

## 24" Dishwasher

GDPH4515AD

- Dual OrbitClean® Wash System
- MaxBoost™ Dry
- Fully-Integrated Controls
- 49 dBA
- SpaceWise® Adjustable Rack
- 34-Minute Quick Wash
- DishSense™ Technology
- 1 - 24 Hour Delay Start

Building the Future, Together.

FRIGIDAIRE

FRIGIDAIRE  
GALLERY

FRIGIDAIRE  
PROFESSIONAL

 Electrolux

# Frigidaire Gallery® Black Stainless Double Oven Package 4

4540-TD 4540-TP

FRIGIDAIRE  
GALLERY



## 30" Double Electric Wall Oven with Total Convection

GCWD3067AD

- Our most advanced and powerful convection system, Total Convection gives you maximum versatility in the kitchen, powering cooking modes like Air Fry, No Preheat, Slow Cook, Convection Bake, Steam Bake, Convection Roast, Steam Roast, Air Sous Vide, Bread Proof, Dehydrate and more!
- Take the guesswork out of cooking with the Temperature Probe
- Premium Touch Screen Control Panel
- Better access to your meals with our Glide Rack



## 36" Gas Cooktop

GCCG3648AB

- Easy to use angled front controls
- Backlit knobs
- Continuous corner-to-corner cast iron grates
- Dishwasher safe
- 5 burners - 12,000 BTU, (2) 9,500 BTU, 7,500 BTU, 18,000 BTU



## 42" Wooden Shiplap Hood



## 2.2 Cu. Ft. Built-In Microwave with Trim Kit

GMBS3068AD/GMTK3068AD

- Extra-large microwave provides 2.2 cu. ft. of cooking space
- Sensor Cooking automatically adjusts power levels and cooking times to cook a variety of items, effortlessly
- Reheat leftovers easily with Sensor Reheat
- Interior LED lighting
- Get meals on the table in minutes with eight different Quick Start options that allow you to start cooking faster



## 24" Dishwasher

GDPH4515AD

- Dual OrbitClean® Wash System
- MaxBoost™ Dry
- Fully-Integrated Controls
- 49 dBA
- SpaceWise® Adjustable Rack
- 34-Minute Quick Wash
- DishSense™ Technology
- 1 - 24 Hour Delay Start

# Frigidaire Gallery® Black Stainless Double Oven Package 3

4540-HL 4540-MQ

FRIGIDAIRE  
GALLERY



## 30" Double Electric Wall Oven with Total Convection

GCWD3067AD

- Our most advanced and powerful convection system, Total Convection gives you maximum versatility in the kitchen, powering cooking modes like Air Fry, No Preheat, Slow Cook, Convection Bake, Steam Bake, Convection Roast, Steam Roast, Air Sous Vide, Bread Proof, Dehydrate and more!
- Take the guesswork out of cooking with the Temperature Probe
- Premium Touch Screen Control Panel
- Better access to your meals with our Glide Rack



## 36" Gas Cooktop

GCCG3648AB

- Easy to use angled front controls
- Backlit knobs
- Continuous corner-to-corner cast iron grates
- Dishwasher safe
- 5 burners - 12,000 BTU, (2) 9,500 BTU, 7,500 BTU, 18,000 BTU

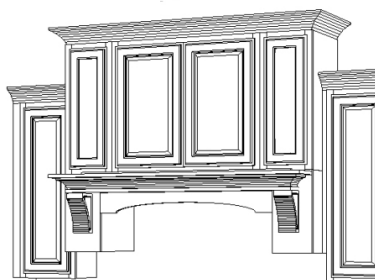

## 62" Wooden Shaker Style Hood



## 2.2 Cu. Ft. Built-In Microwave with Trim Kit

GMBS3068AD/GMTK3068AD

- Extra-large microwave provides 2.2 cu. ft. of cooking space
- Sensor Cooking automatically adjusts power levels and cooking times to cook a variety of items, effortlessly
- Reheat leftovers easily with Sensor Reheat
- Interior LED lighting
- Get meals on the table in minutes with eight different Quick Start options that allow you to start cooking faster



## 24" Dishwasher

GDPH4515AD

- Dual OrbitClean® Wash System
- MaxBoost™ Dry
- Fully-Integrated Controls
- 49 dBA
- SpaceWise® Adjustable Rack
- 34-Minute Quick Wash
- DishSense™ Technology
- 1 - 24 Hour Delay Start



## Frigidaire Professional® Package 1

4540-JQ 4540-M4

**FRIGIDAIRE**  
P R O F E S S I O N A L .



### 30" Single Wall Oven with Total Convection

PCWS3080AF

- Total Convection
- Air Fry
- No Preheat
- ReadyCook™ Air Fry Tray included
- Slow Cook
- Temperature Probe
- Steam Bake
- Glide Rack



### 36" Gas Cooktop

FPGC3677RS

- Stainless Steel Recessed Cooktop
- 5 Sealed Burners
- 18,200 BTU PowerPlus®, 14,000 BTU, (2) 9,500 BTU & 5,000 BTU
- PrecisionPro Controls™
- Continuous Cast Iron Grates
- Low Simmer Burner



### 36" Under-Cabinet Hood

FHWC3625MS

- 220 CFMs
- Rocker Switch Controls
- Fan Blower
- Vertical or Horizontal Air Discharge
- 2 Fan Speeds
- Incandescent Lighting
- Dishwasher-Safe Filters
- Convertible<sup>1</sup> Exhaust Duct

<sup>1</sup> Ventilation is convertible to be either ducted outside, or recirculated inside requiring no ducting. (Recirculated option requires use of a cover.)



### 2.2 Cu. Ft. Built-In Microwave

PMBS3080AF/PMTK3080AF

- Precise cooking with Sensor Cook
- Reheat leftovers easily with Sensor Reheat
- Interior LED lighting
- Convenient Quick Start Options
- Baking is easier with the Melt Feature
- Defrost in no time with the defrost button



### 24" Built-In Dishwasher

FPID2498SF

- Fully-Integrated Pro-Select® Control Panel with Digital Display
- Quieter Decibel Level (dB): 47
- OrbitClean® Wash System
- 7 Wash Cycles / 5 Wash Levels
- Stainless Steel Tub
- SpaceWise® Adjustable Upper Rack
- 1 - 24 Hour Delay Start
- 30-Minute Quick Wash Cycle
- PowerBright™ Floor Light
- EvenDry™ System

Building the Future, Together.

FRIGIDAIRE

FRIGIDAIRE  
GALLERY

FRIGIDAIRE  
PROFESSIONAL

Electrolux

## Frigidaire Professional® Package 2

4540-JS 4540-M5

**FRIGIDAIRE**  
PROFESSIONAL.



### 30" Single Wall Oven with Total Convection

PCWS3080AF

- Total Convection
- Air Fry
- No Preheat
- ReadyCook™ Air Fry Tray included
- Slow Cook
- Temperature Probe
- Steam Bake
- Glide Rack



### 36" Gas Cooktop

FPGC3677RS

- Stainless Steel Recessed Cooktop
- 5 Sealed Burners
- 18,200 BTU PowerPlus®, 14,000 BTU, (2) 9,500 BTU & 5,000 BTU
- PrecisionPro Controls™
- Continuous Cast Iron Grates
- Low Simmer Burner



### 42" Wooden Timberlake Hood



### 2.2 Cu. Ft. Built-In Microwave

PMBS3080AF/PMTK3080AF

- Precise cooking with Sensor Cook
- Reheat leftovers easily with Sensor Reheat
- Interior LED lighting
- Convenient Quick Start Options
- Baking is easier with the Melt Feature
- Defrost in no time with the defrost button



### 24" Built-In Dishwasher

FPID2498SF

- Fully-Integrated Pro-Select® Control Panel with Digital Display
- Quieter Decibel Level (dB): 47
- OrbitClean® Wash System
- 7 Wash Cycles / 5 Wash Levels
- Stainless Steel Tub
- SpaceWise® Adjustable Upper Rack
- 1 - 24 Hour Delay Start
- 30-Minute Quick Wash Cycle
- PowerBright™ Floor Light
- EvenDry™ System

## Frigidaire Professional® Package 6

4540-TE 4540-TQ

**FRIGIDAIRE**  
PROFESSIONAL.



### 30" Single Wall Oven with Total Convection

PCWS3080AF

- Total Convection
- Air Fry
- No Preheat
- ReadyCook™ Air Fry Tray included
- Slow Cook
- Temperature Probe
- Steam Bake
- Glide Rack



### 36" Gas Cooktop

FPGC3677RS

- Stainless Steel Recessed Cooktop
- 5 Sealed Burners
- 18,200 BTU PowerPlus®, 14,000 BTU, (2) 9,500 BTU & 5,000 BTU
- PrecisionPro Controls™
- Continuous Cast Iron Grates
- Low Simmer Burner



### 42" Wooden Shiplap Hood



### 2.2 Cu. Ft. Built-In Microwave

PMBS3080AF/PMTK3080AF

- Precise cooking with Sensor Cook
- Reheat leftovers easily with Sensor Reheat
- Interior LED lighting
- Convenient Quick Start Options
- Baking is easier with the Melt Feature
- Defrost in no time with the defrost button



### 24" Built-In Dishwasher

FPID2498SF

- Fully-Integrated Pro-Select® Control Panel with Digital Display
- Quieter Decibel Level (dB): 47
- OrbitClean® Wash System
- 7 Wash Cycles / 5 Wash Levels
- Stainless Steel Tub
- SpaceWise® Adjustable Upper Rack
- 1 - 24 Hour Delay Start
- 30-Minute Quick Wash Cycle
- PowerBright™ Floor Light
- EvenDry™ System

## Frigidaire Professional® Package 3

4540-JU 4540-M3

**FRIGIDAIRE**  
PROFESSIONAL.



### 30" Single Wall Oven with Total Convection

PCWS3080AF

- Total Convection
- Air Fry
- No Preheat
- ReadyCook™ Air Fry Tray included
- Slow Cook
- Temperature Probe
- Steam Bake
- Glide Rack



### 36" Gas Cooktop

FPGC3677RS

- Stainless Steel Recessed Cooktop
- 5 Sealed Burners
- 18,200 BTU PowerPlus®, 14,000 BTU, (2) 9,500 BTU & 5,000 BTU
- PrecisionPro Controls™
- Continuous Cast Iron Grates
- Low Simmer Burner



### 36" Glass Canopy Wall-Mount Hood

FHWC3660LS

- 400 CFMs
- Electronic Push Button Controls
- Centrifugal Fan
- Vertical Air Discharge
- 3 Fan Speeds
- Dual Halogen Lights
- Dishwasher-Safe Stainless Steel Filters
- Convertible<sup>1</sup> Exhaust Duct

<sup>1</sup> Ventilation is convertible to be either ducted outside, or recirculated inside requiring no ducting. (Recirculated option requires optional duct-free kit.)



### 2.2 Cu. Ft. Built-In Microwave

PMBS3080AF/PMTK3080AF

- Precise cooking with Sensor Cook
- Reheat leftovers easily with Sensor Reheat
- Interior LED lighting
- Convenient Quick Start Options
- Baking is easier with the Melt Feature
- Defrost in no time with the defrost button



### 24" Built-In Dishwasher

FPID2498SF

- Fully-Integrated Pro-Select® Control Panel with Digital Display
- Quieter Decibel Level (dB): 47
- OrbitClean® Wash System
- 7 Wash Cycles / 5 Wash Levels
- Stainless Steel Tub
- SpaceWise® Adjustable Upper Rack
- 1 - 24 Hour Delay Start
- 30-Minute Quick Wash Cycle
- PowerBright™ Floor Light
- EvenDry™ System

## Frigidaire Professional® Package 4

4540-K8 4540-P3

**FRIGIDAIRE**  
PROFESSIONAL.



### 30" Single Wall Oven with Total Convection

PCWS3080AF

- Total Convection
- Air Fry
- No Preheat
- ReadyCook™ Air Fry Tray included
- Slow Cook
- Temperature Probe
- Steam Bake
- Glide Rack



### 36" Gas Cooktop

FPGC3677RS

- Stainless Steel Recessed Cooktop
- 5 Sealed Burners
- 18,200 BTU PowerPlus®, 14,000 BTU, (2) 9,500 BTU & 5,000 BTU
- PrecisionPro Controls™
- Continuous Cast Iron Grates
- Low Simmer Burner

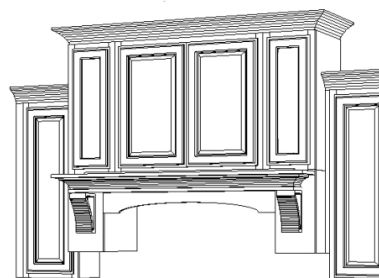

### 62" Wooden Shaker Style Hood



### 2.2 Cu. Ft. Built-In Microwave

PMBS3080AF/PMTK3080AF

- Precise cooking with Sensor Cook
- Reheat leftovers easily with Sensor Reheat
- Interior LED lighting
- Convenient Quick Start Options
- Baking is easier with the Melt Feature
- Defrost in no time with the defrost button



### 24" Built-In Dishwasher

FPID2498SF

- Fully-Integrated Pro-Select® Control Panel with Digital Display
- Quieter Decibel Level (dB): 47
- OrbitClean® Wash System
- 7 Wash Cycles / 5 Wash Levels
- Stainless Steel Tub
- SpaceWise® Adjustable Upper Rack
- 1 - 24 Hour Delay Start
- 30-Minute Quick Wash Cycle
- PowerBright™ Floor Light
- EvenDry™ System



## Frigidaire Professional® Package 5

4540-LA 4540-NA

**FRIGIDAIRE**  
PROFESSIONAL.



### 30" Single Wall Oven with Total Convection

PCWS3080AF

- Total Convection
- Air Fry
- No Preheat
- ReadyCook™ Air Fry Tray included
- Slow Cook
- Temperature Probe
- Steam Bake
- Glide Rack



### 36" Gas Cooktop

FPGC3677RS

- Stainless Steel Recessed Cooktop
- 5 Sealed Burners
- 18,200 BTU PowerPlus®, 14,000 BTU, (2) 9,500 BTU & 5,000 BTU
- PrecisionPro Controls™
- Continuous Cast Iron Grates
- Low Simmer Burner



### 36" Wall-Mount Hood

FHWC3655LS

- Stainless Steel Canopy
- 400 CFMs
- Electronic Push Button Controls
- Centrifugal Fan
- Vertical Air Discharge
- 3 Fan Speeds
- Dual Halogen Lights
- Dishwasher-Safe Stainless Steel Filters
- Convertible<sup>1</sup> Exhaust Duct

<sup>1</sup>Ventilation is convertible to be either ducted outside, or recirculated inside requiring no ducting. (Recirculated option requires use of an optional Duct-Free Kit.)



### 2.2 Cu. Ft. Built-In Microwave

PMBS3080AF/PMTK3080AF

- Precise cooking with Sensor Cook
- Reheat leftovers easily with Sensor Reheat
- Interior LED lighting
- Convenient Quick Start Options
- Baking is easier with the Melt Feature
- Defrost in no time with the defrost button



### 24" Built-In Dishwasher

FPID2498SF

- Fully-Integrated Pro-Select® Control Panel with Digital Display
- Quieter Decibel Level (dB): 47
- OrbitClean® Wash System
- 7 Wash Cycles / 5 Wash Levels
- Stainless Steel Tub
- SpaceWise® Adjustable Upper Rack
- 1 - 24 Hour Delay Start
- 30-Minute Quick Wash Cycle
- PowerBright™ Floor Light
- EvenDry™ System

## Frigidaire Professional® Package 1

4540-RA 4540-QA

**FRIGIDAIRE**  
P R O F E S S I O N A L .



### 30" Single Wall Oven with Total Convection

PCWS3080AF

- Total Convection
- Air Fry
- No Preheat
- ReadyCook™ Air Fry Tray included
- Slow Cook
- Temperature Probe
- Steam Bake
- Glide Rack



### 36" Dual-Fuel Freestanding Range

ECFD3668AS

- Create the perfect soufflé in the oven and precisely sear meats on the cooktop with Dual Fuel, the ideal combination of a gas cooktop and electric oven for delicious results
- Achieve accurate, efficient temperature control - whether you need a roaring boil or a bare simmer - with Two Dual Brass Power Burners
- Create specialty foods like crepes and paninis with the Integrated Griddle
- Six Flexible Dual Burners allow you to cook multiple dishes at once
- True Convection uses three heating elements and a fan for even cooking results



### 36" Under-Cabinet Hood

FHWC3625MS

- 220 CFMs
- Rocker Switch Controls
- Fan Blower
- Vertical or Horizontal Air Discharge
- 2 Fan Speeds
- Incandescent Lighting
- Dishwasher-Safe Filters
- Convertible<sup>1</sup> Exhaust Duct

<sup>1</sup> Ventilation is convertible to be either ducted outside, or recirculated inside requiring no ducting. (Recirculated option requires use of a cover.)



### 2.2 Cu. Ft. Built-In Microwave

PMBS3080AF/PMTK3080AF

- Precise cooking with Sensor Cook
- Reheat leftovers easily with Sensor Reheat
- Interior LED lighting
- Convenient Quick Start Options
- Baking is easier with the Melt Feature
- Defrost in no time with the defrost button



### 24" Built-In Dishwasher

FPID2498SF

- Fully-Integrated Pro-Select® Control Panel with Digital Display
- Quieter Decibel Level (dB): 47
- OrbitClean® Wash System
- 7 Wash Cycles / 5 Wash Levels
- Stainless Steel Tub
- SpaceWise® Adjustable Upper Rack
- 1 - 24 Hour Delay Start
- 30-Minute Quick Wash Cycle
- PowerBright™ Floor Light
- EvenDry™ System

## Frigidaire Professional® Package 2

4540-RB 4540-QB

**FRIGIDAIRE**  
P R O F E S S I O N A L .



### 30" Single Wall Oven with Total Convection

PCWS3080AF

- Total Convection
- Air Fry
- No Preheat
- ReadyCook™ Air Fry Tray included
- Slow Cook
- Temperature Probe
- Steam Bake
- Glide Rack



### 36" Dual-Fuel Freestanding Range

ECFD3668AS

- Create the perfect soufflé in the oven and precisely sear meats on the cooktop with Dual Fuel, the ideal combination of a gas cooktop and electric oven for delicious results
- Achieve accurate, efficient temperature control - whether you need a roaring boil or a bare simmer - with Two Dual Brass Power Burners
- Create specialty foods like crepes and paninis with the Integrated Griddle
- Six Flexible Dual Burners allow you to cook multiple dishes at once
- True Convection uses three heating elements and a fan for even cooking results



### 42" Wooden Timberlake Hood



### 2.2 Cu. Ft. Built-In Microwave

PMBS3080AF/PMTK3080AF

- Precise cooking with Sensor Cook
- Reheat leftovers easily with Sensor Reheat
- Interior LED lighting
- Convenient Quick Start Options
- Baking is easier with the Melt Feature
- Defrost in no time with the defrost button



### 24" Built-In Dishwasher

FPID2498SF

- Fully-Integrated Pro-Select® Control Panel with Digital Display
- Quieter Decibel Level (dB): 47
- OrbitClean® Wash System
- 7 Wash Cycles / 5 Wash Levels
- Stainless Steel Tub
- SpaceWise® Adjustable Upper Rack
- 1 - 24 Hour Delay Start
- 30-Minute Quick Wash Cycle
- PowerBright™ Floor Light
- EvenDry™ System

## Frigidaire Professional® Package 6

4540-TG 4540-TS

**FRIGIDAIRE**  
PROFESSIONAL.



### 30" Single Wall Oven with Total Convection

PCWS3080AF

- Total Convection
- Air Fry
- No Preheat
- ReadyCook™ Air Fry Tray included
- Slow Cook
- Temperature Probe
- Steam Bake
- Glide Rack



### 36" Dual-Fuel Freestanding Range

ECFD3668AS

- Create the perfect soufflé in the oven and precisely sear meats on the cooktop with Dual Fuel, the ideal combination of a gas cooktop and electric oven for delicious results
- Achieve accurate, efficient temperature control - whether you need a roaring boil or a bare simmer - with Two Dual Brass Power Burners
- Create specialty foods like crepes and paninis with the Integrated Griddle
- Six Flexible Dual Burners allow you to cook multiple dishes at once
- True Convection uses three heating elements and a fan for even cooking results



### 42" Wooden Shiplap Hood



### 2.2 Cu. Ft. Built-In Microwave

PMBS3080AF/PMTK3080AF

- Precise cooking with Sensor Cook
- Reheat leftovers easily with Sensor Reheat
- Interior LED lighting
- Convenient Quick Start Options
- Baking is easier with the Melt Feature
- Defrost in no time with the defrost button



### 24" Built-In Dishwasher

FPID2498SF

- Fully-Integrated Pro-Select® Control Panel with Digital Display
- Quieter Decibel Level (dB): 47
- OrbitClean® Wash System
- 7 Wash Cycles / 5 Wash Levels
- Stainless Steel Tub
- SpaceWise® Adjustable Upper Rack
- 1 - 24 Hour Delay Start
- 30-Minute Quick Wash Cycle
- PowerBright™ Floor Light
- EvenDry™ System

## Frigidaire Professional® Package 3

4540-RC 4540-QC

**FRIGIDAIRE**  
PROFESSIONAL.



### 30" Single Wall Oven with Total Convection

PCWS3080AF

- Total Convection
- Air Fry
- No Preheat
- ReadyCook™ Air Fry Tray included
- Slow Cook
- Temperature Probe
- Steam Bake
- Glide Rack



### 36" Dual-Fuel Freestanding Range

ECFD3668AS

- Create the perfect soufflé in the oven and precisely sear meats on the cooktop with Dual Fuel, the ideal combination of a gas cooktop and electric oven for delicious results
- Achieve accurate, efficient temperature control - whether you need a roaring boil or a bare simmer - with Two Dual Brass Power Burners
- Create specialty foods like crepes and paninis with the Integrated Griddle
- Six Flexible Dual Burners allow you to cook multiple dishes at once
- True Convection uses three heating elements and a fan for even cooking results



### 36" Glass Canopy Wall-Mount Hood

FHWC3660LS

- 400 CFMs
- Electronic Push Button Controls
- Centrifugal Fan
- Vertical Air Discharge
- 3 Fan Speeds
- Dual Halogen Lights
- Dishwasher-Safe Stainless Steel Filters
- Convertible<sup>1</sup> Exhaust Duct

<sup>1</sup> Ventilation is convertible to be either ducted outside, or recirculated inside requiring no ducting. (Recirculated option requires optional duct-free kit.)



### 2.2 Cu. Ft. Built-In Microwave

PMBS3080AF/PMTK3080AF

- Precise cooking with Sensor Cook
- Reheat leftovers easily with Sensor Reheat
- Interior LED lighting
- Convenient Quick Start Options
- Baking is easier with the Melt Feature
- Defrost in no time with the defrost button



### 24" Built-In Dishwasher

FPID2498SF

- Fully-Integrated Pro-Select® Control Panel with Digital Display
- Quieter Decibel Level (dB): 47
- OrbitClean® Wash System
- 7 Wash Cycles / 5 Wash Levels
- Stainless Steel Tub
- SpaceWise® Adjustable Upper Rack
- 1 - 24 Hour Delay Start
- 30-Minute Quick Wash Cycle
- PowerBright™ Floor Light
- EvenDry™ System



## Frigidaire Professional® Package 4

4540-RD 4540-QD

**FRIGIDAIRE**  
PROFESSIONAL.



### 30" Single Wall Oven with Total Convection

PCWS3080AF

- Total Convection
- Air Fry
- No Preheat
- ReadyCook™ Air Fry Tray included
- Slow Cook
- Temperature Probe
- Steam Bake
- Glide Rack



### 36" Dual-Fuel Freestanding Range

ECFD3668AS

- Create the perfect soufflé in the oven and precisely sear meats on the cooktop with Dual Fuel, the ideal combination of a gas cooktop and electric oven for delicious results
- Achieve accurate, efficient temperature control - whether you need a roaring boil or a bare simmer - with Two Dual Brass Power Burners
- Create specialty foods like crepes and paninis with the Integrated Griddle
- Six Flexible Dual Burners allow you to cook multiple dishes at once
- True Convection uses three heating elements and a fan for even cooking results

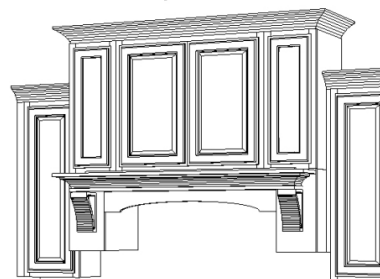

### 62" Wooden Shaker Style Hood



### 2.2 Cu. Ft. Built-In Microwave

PMBS3080AF/PMTK3080AF

- Precise cooking with Sensor Cook
- Reheat leftovers easily with Sensor Reheat
- Interior LED lighting
- Convenient Quick Start Options
- Baking is easier with the Melt Feature
- Defrost in no time with the defrost button



### 24" Built-In Dishwasher

FPID2498SF

- Fully-Integrated Pro-Select® Control Panel with Digital Display
- Quieter Decibel Level (dB): 47
- OrbitClean® Wash System
- 7 Wash Cycles / 5 Wash Levels
- Stainless Steel Tub
- SpaceWise® Adjustable Upper Rack
- 1 - 24 Hour Delay Start
- 30-Minute Quick Wash Cycle
- PowerBright™ Floor Light
- EvenDry™ System

## Frigidaire Professional® Package 5

4540-LC / 4540-NC

**FRIGIDAIRE**  
PROFESSIONAL.



### 30" Single Wall Oven with Total Convection

PCWS3080AF

- Total Convection
- Air Fry
- No Preheat
- ReadyCook™ Air Fry Tray included
- Slow Cook
- Temperature Probe
- Steam Bake
- Glide Rack



### 36" Dual-Fuel Freestanding Range

ECFD3668AS

- Create the perfect soufflé in the oven and precisely sear meats on the cooktop with Dual Fuel, the ideal combination of a gas cooktop and electric oven for delicious results
- Achieve accurate, efficient temperature control - whether you need a roaring boil or a bare simmer - with Two Dual Brass Power Burners
- Create specialty foods like crepes and paninis with the Integrated Griddle
- Six Flexible Dual Burners allow you to cook multiple dishes at once
- True Convection uses three heating elements and a fan for even cooking results



### 36" Wall-Mount Hood

FHWC3655LS

- Stainless Steel Canopy
- 400 CFMs
- Electronic Push Button Controls
- Centrifugal Fan
- Vertical Air Discharge
- 3 Fan Speeds
- Dual Halogen Lights
- Dishwasher-Safe Stainless Steel Filters
- Convertible<sup>1</sup> Exhaust Duct

<sup>1</sup>Ventilation is convertible to be either ducted outside, or recirculated inside requiring no ducting. (Recirculated option requires use of an optional Duct-Free Kit.)



### 2.2 Cu. Ft. Built-In Microwave

PMBS3080AF/PMTK3080AF

- Precise cooking with Sensor Cook
- Reheat leftovers easily with Sensor Reheat
- Interior LED lighting
- Convenient Quick Start Options
- Baking is easier with the Melt Feature
- Defrost in no time with the defrost button



### 24" Built-In Dishwasher

FPID2498SF

- Fully-Integrated Pro-Select® Control Panel with Digital Display
- Quieter Decibel Level (dB): 47
- OrbitClean® Wash System
- 7 Wash Cycles / 5 Wash Levels
- Stainless Steel Tub
- SpaceWise® Adjustable Upper Rack
- 1 - 24 Hour Delay Start
- 30-Minute Quick Wash Cycle
- PowerBright™ Floor Light
- EvenDry™ System

# Frigidaire Professional® Double Oven Package 1

4540-JP / 4540-OB

**FRIGIDAIRE**  
PROFESSIONAL.



## 30" Double Wall Oven with Total Convection

PCWD3080AF

- Our most advanced and powerful convection system, Total Convection - in both ovens
- Start baking immediately with No Preheat
- Deliver all of the flavor and none of the guilt with Air Fry
- ReadyCook™ Air Fry Tray included
- Experience a hassle-free way to cook with Slow Cook
- Achieve bakery results at home with Steam Bake



## 36" Gas Cooktop

FPGC3677RS

- Stainless Steel Recessed Cooktop
- 5 Sealed Burners
- 18,200 BTU PowerPlus®, 14,000 BTU, (2) 9,500 BTU & 5,000 BTU
- PrecisionPro Controls™
- Continuous Cast Iron Grates
- Low Simmer Burner



## 36" Under-Cabinet Hood

FHWC3625MS

- 220 CFMs
- Rocker Switch Controls
- Fan Blower
- Vertical or Horizontal Air Discharge
- 2 Fan Speeds
- Incandescent Lighting
- Dishwasher-Safe Filters
- Convertible<sup>1</sup> Exhaust Duct

<sup>1</sup> Ventilation is convertible to be either ducted outside, or recirculated inside requiring no ducting. (Recirculated option requires use of a cover.)



## 2.2 Cu. Ft. Built-In Microwave

PMBS3080AF/PMTK3080AF

- Precise cooking with Sensor Cook
- Reheat leftovers easily with Sensor Reheat
- Interior LED lighting
- Convenient Quick Start Options
- Baking is easier with the Melt Feature
- Defrost in no time with the defrost button



## 24" Built-In Dishwasher

FPID2498SF

- Fully-Integrated Pro-Select® Control Panel with Digital Display
- Quieter Decibel Level (dB): 47
- OrbitClean® Wash System
- 7 Wash Cycles / 5 Wash Levels
- Stainless Steel Tub
- SpaceWise® Adjustable Upper Rack
- 1 - 24 Hour Delay Start
- 30-Minute Quick Wash Cycle
- PowerBright™ Floor Light
- EvenDry™ System

## Frigidaire Professional® Double Oven Package 2

4540-JT / 4540-O6

**FRIGIDAIRE**  
PROFESSIONAL.



### 30" Double Wall Oven with Total Convection

PCWD3080AF

- Our most advanced and powerful convection system, Total Convection - in both ovens
- Start baking immediately with No Preheat
- Deliver all of the flavor and none of the guilt with Air Fry
- ReadyCook™ Air Fry Tray included
- Experience a hassle-free way to cook with Slow Cook
- Achieve bakery results at home with Steam Bake



### 36" Gas Cooktop

FPGC3677RS

- Stainless Steel Recessed Cooktop
- 5 Sealed Burners
- 18,200 BTU PowerPlus®, 14,000 BTU, (2) 9,500 BTU & 5,000 BTU
- PrecisionPro Controls™
- Continuous Cast Iron Grates
- Low Simmer Burner



### 42" Wooden Timberlake Hood



### 2.2 Cu. Ft. Built-In Microwave

PMBS3080AF/PMTK3080AF

- Precise cooking with Sensor Cook
- Reheat leftovers easily with Sensor Reheat
- Interior LED lighting
- Convenient Quick Start Options
- Baking is easier with the Melt Feature
- Defrost in no time with the defrost button



### 24" Built-In Dishwasher

FPID2498SF

- Fully-Integrated Pro-Select® Control Panel with Digital Display
- Quieter Decibel Level (dB): 47
- OrbitClean® Wash System
- 7 Wash Cycles / 5 Wash Levels
- Stainless Steel Tub
- SpaceWise® Adjustable Upper Rack
- 1 - 24 Hour Delay Start
- 30-Minute Quick Wash Cycle
- PowerBright™ Floor Light
- EvenDry™ System

## Frigidaire Professional® Double Oven Package 6

4540-TF / 4540-TR

**FRIGIDAIRE**  
PROFESSIONAL.



### 30" Double Wall Oven with Total Convection

PCWD3080AF

- Our most advanced and powerful convection system, Total Convection - in both ovens
- Start baking immediately with No Preheat
- Deliver all of the flavor and none of the guilt with Air Fry
- ReadyCook™ Air Fry Tray included
- Experience a hassle-free way to cook with Slow Cook
- Achieve bakery results at home with Steam Bake

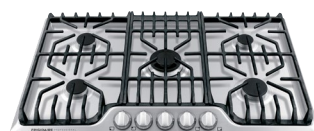

### 36" Gas Cooktop

FPGC3677RS

- Stainless Steel Recessed Cooktop
- 5 Sealed Burners
- 18,200 BTU PowerPlus®, 14,000 BTU, (2) 9,500 BTU & 5,000 BTU
- PrecisionPro Controls™
- Continuous Cast Iron Grates
- Low Simmer Burner



### 42" Wooden Shiplap Hood



### 2.2 Cu. Ft. Built-In Microwave

PMBS3080AF/PMTK3080AF

- Precise cooking with Sensor Cook
- Reheat leftovers easily with Sensor Reheat
- Interior LED lighting
- Convenient Quick Start Options
- Baking is easier with the Melt Feature
- Defrost in no time with the defrost button



### 24" Built-In Dishwasher

FPID2498SF

- Fully-Integrated Pro-Select® Control Panel with Digital Display
- Quieter Decibel Level (dB): 47
- OrbitClean® Wash System
- 7 Wash Cycles / 5 Wash Levels
- Stainless Steel Tub
- SpaceWise® Adjustable Upper Rack
- 1 - 24 Hour Delay Start
- 30-Minute Quick Wash Cycle
- PowerBright™ Floor Light
- EvenDry™ System



## Frigidaire Professional® Double Oven Package 3

4540-JR / 4540-N7

**FRIGIDAIRE**  
PROFESSIONAL.



### 30" Double Wall Oven with Total Convection

PCWD3080AF

- Our most advanced and powerful convection system, Total Convection - in both ovens
- Start baking immediately with No Preheat
- Deliver all of the flavor and none of the guilt with Air Fry
- ReadyCook™ Air Fry Tray included
- Experience a hassle-free way to cook with Slow Cook
- Achieve bakery results at home with Steam Bake



### 36" Gas Cooktop

FPGC3677RS

- Stainless Steel Recessed Cooktop
- 5 Sealed Burners
- 18,200 BTU PowerPlus®, 14,000 BTU, (2) 9,500 BTU & 5,000 BTU
- PrecisionPro Controls™
- Continuous Cast Iron Grates
- Low Simmer Burner



### 36" Glass Canopy Wall-Mount Hood

FHWC3660LS

- 400 CFMs
- Electronic Push Button Controls
- Centrifugal Fan
- Vertical Air Discharge
- 3 Fan Speeds
- Dual Halogen Lights
- Dishwasher-Safe Stainless Steel Filters
- Convertible<sup>1</sup> Exhaust Duct

<sup>1</sup> Ventilation is convertible to be either ducted outside, or recirculated inside requiring no ducting. (Recirculated option requires optional duct-free kit.)



### 2.2 Cu. Ft. Built-In Microwave

PMBS3080AF/PMTK3080AF

- Precise cooking with Sensor Cook
- Reheat leftovers easily with Sensor Reheat
- Interior LED lighting
- Convenient Quick Start Options
- Baking is easier with the Melt Feature
- Defrost in no time with the defrost button



### 24" Built-In Dishwasher

FPID2498SF

- Fully-Integrated Pro-Select® Control Panel with Digital Display
- Quieter Decibel Level (dB): 47
- OrbitClean® Wash System
- 7 Wash Cycles / 5 Wash Levels
- Stainless Steel Tub
- SpaceWise® Adjustable Upper Rack
- 1 - 24 Hour Delay Start
- 30-Minute Quick Wash Cycle
- PowerBright™ Floor Light
- EvenDry™ System

# Frigidaire Professional® Double Oven Package

4

4540-K9 / 4540-P4

**FRIGIDAIRE**  
PROFESSIONAL.

**NEWMARK**  
HOMES



## 30" Double Wall Oven with Total Convection

PCWD3080AF

- Our most advanced and powerful convection system, Total Convection - in both ovens
- Start baking immediately with No Preheat
- Deliver all of the flavor and none of the guilt with Air Fry
- ReadyCook™ Air Fry Tray included
- Experience a hassle-free way to cook with Slow Cook
- Achieve bakery results at home with Steam Bake



## 36" Gas Cooktop

FPGC3677RS

- Stainless Steel Recessed Cooktop
- 5 Sealed Burners
- 18,200 BTU PowerPlus®, 14,000 BTU, (2) 9,500 BTU & 5,000 BTU
- PrecisionPro Controls™
- Continuous Cast Iron Grates
- Low Simmer Burner

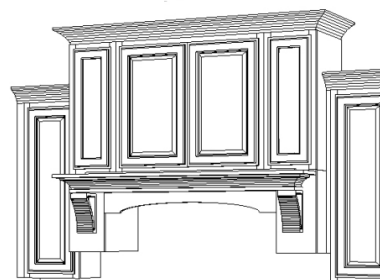

## 62" Wooden Shaker Style Hood



## 2.2 Cu. Ft. Built-In Microwave

PMBS3080AF/PMTK3080AF

- Precise cooking with Sensor Cook
- Reheat leftovers easily with Sensor Reheat
- Interior LED lighting
- Convenient Quick Start Options
- Baking is easier with the Melt Feature
- Defrost in no time with the defrost button



## 24" Built-In Dishwasher

FPID2498SF

- Fully-Integrated Pro-Select® Control Panel with Digital Display
- Quieter Decibel Level (dB): 47
- OrbitClean® Wash System
- 7 Wash Cycles / 5 Wash Levels
- Stainless Steel Tub
- SpaceWise® Adjustable Upper Rack
- 1 - 24 Hour Delay Start
- 30-Minute Quick Wash Cycle
- PowerBright™ Floor Light
- EvenDry™ System

Building the Future, Together.

FRIGIDAIRE

FRIGIDAIRE  
GALLERY

FRIGIDAIRE  
PROFESSIONAL

 Electrolux

## Frigidaire Professional® Double Oven Package 5

4540-LB / 4540-NB

**FRIGIDAIRE**  
PROFESSIONAL.



### 30" Double Wall Oven with Total Convection

PCWD3080AF

- Our most advanced and powerful convection system, Total Convection - in both ovens
- Start baking immediately with No Preheat
- Deliver all of the flavor and none of the guilt with Air Fry
- ReadyCook™ Air Fry Tray included
- Experience a hassle-free way to cook with Slow Cook
- Achieve bakery results at home with Steam Bake



### 36" Gas Cooktop

FPGC3677RS

- Stainless Steel Recessed Cooktop
- 5 Sealed Burners
- 18,200 BTU PowerPlus®, 14,000 BTU, (2) 9,500 BTU & 5,000 BTU
- PrecisionPro Controls™
- Continuous Cast Iron Grates
- Low Simmer Burner



### 36" Wall-Mount Hood

FHWC3655LS

- Stainless Steel Canopy
- 400 CFMs
- Electronic Push Button Controls
- Centrifugal Fan
- Vertical Air Discharge
- 3 Fan Speeds
- Dual Halogen Lights
- Dishwasher-Safe Stainless Steel Filters
- Convertible<sup>1</sup> Exhaust Duct

<sup>1</sup>Ventilation is convertible to be either ducted outside, or recirculated inside requiring no ducting. (Recirculated option requires use of an optional Duct-Free Kit.)



### 2.2 Cu. Ft. Built-In Microwave

PMBS3080AF/PMTK3080AF

- Precise cooking with Sensor Cook
- Reheat leftovers easily with Sensor Reheat
- Interior LED lighting
- Convenient Quick Start Options
- Baking is easier with the Melt Feature
- Defrost in no time with the defrost button



### 24" Built-In Dishwasher

FPID2498SF

- Fully-Integrated Pro-Select® Control Panel with Digital Display
- Quieter Decibel Level (dB): 47
- OrbitClean® Wash System
- 7 Wash Cycles / 5 Wash Levels
- Stainless Steel Tub
- SpaceWise® Adjustable Upper Rack
- 1 - 24 Hour Delay Start
- 30-Minute Quick Wash Cycle
- PowerBright™ Floor Light
- EvenDry™ System

## Electrolux Cooktop Package 1

4540-EA / 4540-FA



### 30" Connected Wall Oven with Air Sous Vide

ECWS3012AS

- Exclusive Air Sous Vide locks in moisture and preserves natural flavors to provide juicy results
- Steam Cooking enhances the natural flavor of foods- from steaks to breads- by creating a crisp golden crust and juicy, flavorful inside
- Electrolux Connect Technology allows for setting, preheating, and monitoring cook times remotely, all from an app



### 36" Gas Cooktop

ECCG3668AS

- Striking Design features sturdy LED backlit knobs, cast-iron grates, and brass accents
- High Power Brass Burner allows for accurate, efficient temperature control whether boiling or simmering
- Deep-Well Design provides an easy cleanup



### 36" Glass Canopy Wall-Mount Hood

FHWC3660LS

- 400 CFMs
- Electronic Push Button Controls
- Centrifugal Fan
- Vertical Air Discharge
- 3 Fan Speeds
- Dual Halogen Lights
- Dishwasher-Safe Stainless Steel Filters
- Convertible<sup>1</sup> Exhaust Duct

<sup>1</sup> Ventilation is convertible to be either ducted outside, or recirculated inside requiring no ducting. (Recirculated option requires optional duct-free kit.)



### 30" Built-In Microwave Oven with Drop-Down Door

EMBD3010AS

- Sleek design with glass touch controls
- Convection Cooking
- Sensor Cook Function
- Multi-Stage Cooking
- Preheat/Keep Warm Mode
- Combi Cooking combines the speed of a microwave with the browning and crisping power of convection
- Premium LED Lighting



### 24" Dishwasher

EDSH4944AS

- Get a Sparkling Clean with the LuxCare® Wash Arm
- Perfect Dry® System Gets Dishes Dry the First Time
- 30-Minute Clean Cycle
- Third-Level Rack
- Target Wash Zones
- Convenient LED Floor Beam Indicators
- National Sanitation Foundation® Certified
- Clean Dishes of All Sizes
- Quiet Operation with Luxury-Quiet System

## Electrolux Cooktop Package 2

4540-EB / 4540-FB



**30" Connected Wall  
Oven with Air Sous Vide**  
ECWS3012AS

- Exclusive Air Sous Vide locks in moisture and preserves natural flavors to provide juicy results
- Steam Cooking enhances the natural flavor of foods- from steaks to breads- by creating a crisp golden crust and juicy, flavorful inside
- Electrolux Connect Technology allows for setting, preheating, and monitoring cook times remotely, all from an app



**36" Gas Cooktop**  
ECCG3668AS

- Striking Design features sturdy LED backlit knobs, cast-iron grates, and brass accents
- High Power Brass Burner allows for accurate, efficient temperature control whether boiling or simmering
- Deep-Well Design provides an easy cleanup



**36" Hands-  
Free Hood with  
Responsive Sensors**  
ECVW3662AS

- Responsive Sensor
- Perimeter Venting
- Sleek Design
- Premium LED Lighting
- Quieter fan operation for powerful performance with less noise



**30" Built-In  
Microwave Oven with  
Drop-Down Door**  
EMBD3010AS

- Sleek design with glass touch controls
- Convection Cooking
- Sensor Cook Function
- Multi-Stage Cooking
- Preheat/Keep Warm Mode
- Combi Cooking combines the speed of a microwave with the browning and crisping power of convection
- Premium LED Lighting



**24" Dishwasher**  
EDSH4944AS

- Get a Sparkling Clean with the LuxCare® Wash Arm
- Perfect Dry® System Gets Dishes Dry the First Time
- 30-Minute Clean Cycle
- Third-Level Rack
- Target Wash Zones
- Convenient LED Floor Beam Indicators
- National Sanitation Foundation® Certified
- Clean Dishes of All Sizes
- Quiet Operation with Luxury-Quiet System



## Electrolux Cooktop Package 3

4540-EC / 4540-FC



### 30" Connected Wall Oven with Air Sous Vide

ECWS3012AS

- Exclusive Air Sous Vide locks in moisture and preserves natural flavors to provide juicy results
- Steam Cooking enhances the natural flavor of foods- from steaks to breads- by creating a crisp golden crust and juicy, flavorful inside
- Electrolux Connect Technology allows for setting, preheating, and monitoring cook times remotely, all from an app



### 36" Gas Cooktop

ECCG3668AS

- Striking Design features sturdy LED backlit knobs, cast-iron grates, and brass accents
- High Power Brass Burner allows for accurate, efficient temperature control whether boiling or simmering
- Deep-Well Design provides an easy cleanup



### 42" Wooden Timberlake Hood



### 30" Built-In Microwave Oven with Drop-Down Door

EMBD3010AS

- Sleek design with glass touch controls
- Convection Cooking
- Sensor Cook Function
- Multi-Stage Cooking
- Preheat/Keep Warm Mode
- Combi Cooking combines the speed of a microwave with the browning and crisping power of convection
- Premium LED Lighting



### 24" Dishwasher

EDSH4944AS

- Get a Sparkling Clean with the LuxCare® Wash Arm
- Perfect Dry® System Gets Dishes Dry the First Time
- 30-Minute Clean Cycle
- Third-Level Rack
- Target Wash Zones
- Convenient LED Floor Beam Indicators
- National Sanitation Foundation® Certified
- Clean Dishes of All Sizes
- Quiet Operation with Luxury-Quiet System

## Electrolux Cooktop Package 5

4540-TH / 4540-TT



### 30" Connected Wall Oven with Air Sous Vide

ECWS3012AS

- Exclusive Air Sous Vide locks in moisture and preserves natural flavors to provide juicy results
- Steam Cooking enhances the natural flavor of foods- from steaks to breads- by creating a crisp golden crust and juicy, flavorful inside
- Electrolux Connect Technology allows for setting, preheating, and monitoring cook times remotely, all from an app



### 36" Gas Cooktop

ECCG3668AS

- Striking Design features sturdy LED backlit knobs, cast-iron grates, and brass accents
- High Power Brass Burner allows for accurate, efficient temperature control whether boiling or simmering
- Deep-Well Design provides an easy cleanup



### 42" Wooden Shiplap Hood



### 30" Built-In Microwave Oven with Drop-Down Door

EMBD3010AS

- Sleek design with glass touch controls
- Convection Cooking
- Sensor Cook Function
- Multi-Stage Cooking
- Preheat/Keep Warm Mode
- Combi Cooking combines the speed of a microwave with the browning and crisping power of convection
- Premium LED Lighting



### 24" Dishwasher

EDSH4944AS

- Get a Sparkling Clean with the LuxCare® Wash Arm
- Perfect Dry® System Gets Dishes Dry the First Time
- 30-Minute Clean Cycle
- Third-Level Rack
- Target Wash Zones
- Convenient LED Floor Beam Indicators
- National Sanitation Foundation® Certified
- Clean Dishes of All Sizes
- Quiet Operation with Luxury-Quiet System

## Electrolux Cooktop Package 4

4540-ED / 4540-FD



### 30" Connected Wall Oven with Air Sous Vide

ECWS3012AS

- Exclusive Air Sous Vide locks in moisture and preserves natural flavors to provide juicy results
- Steam Cooking enhances the natural flavor of foods- from steaks to breads- by creating a crisp golden crust and juicy, flavorful inside
- Electrolux Connect Technology allows for setting, preheating, and monitoring cook times remotely, all from an app



### 36" Gas Cooktop

ECCG3668AS

- Striking Design features sturdy LED backlit knobs, cast-iron grates, and brass accents
- High Power Brass Burner allows for accurate, efficient temperature control whether boiling or simmering
- Deep-Well Design provides an easy cleanup

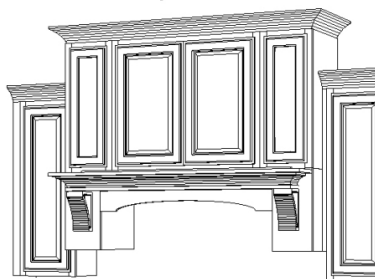

### 62" Wooden Shaker Style Hood



### 30" Built-In Microwave Oven with Drop-Down Door

EMBD3010AS

- Sleek design with glass touch controls
- Convection Cooking
- Sensor Cook Function
- Multi-Stage Cooking
- Preheat/Keep Warm Mode
- Combi Cooking combines the speed of a microwave with the browning and crisping power of convection
- Premium LED Lighting



### 24" Dishwasher

EDSH4944AS

- Get a Sparkling Clean with the LuxCare® Wash Arm
- Perfect Dry® System Gets Dishes Dry the First Time
- 30-Minute Clean Cycle
- Third-Level Rack
- Target Wash Zones
- Convenient LED Floor Beam Indicators
- National Sanitation Foundation® Certified
- Clean Dishes of All Sizes
- Quiet Operation with Luxury-Quiet System

## Electrolux Rangetop Package 1

4540-EE / 4540-FE



### 30" Connected Wall Oven with Air Sous Vide

ECWS3012AS

- Exclusive Air Sous Vide locks in moisture and preserves natural flavors to provide juicy results
- Steam Cooking enhances the natural flavor of foods- from steaks to breads- by creating a crisp golden crust and juicy, flavorful inside
- Electrolux Connect Technology allows for setting, preheating, and monitoring cook times remotely, all from an app



### 36" Gas Rangetop

ECCG3672AS

- Striking Design features sturdy LED backlit knobs, cast-iron grates, and brass accents
- Two Dual Brass Power Burners allow for accurate, efficient temperature control whether boiling or simmering
- Six Flexible Dual Burners allow for cooking multiple dishes with ease



### 36" Glass Canopy Wall-Mount Hood

FHWC3660LS

- 400 CFMs
- Electronic Push Button Controls
- Centrifugal Fan
- Vertical Air Discharge
- 3 Fan Speeds
- Dual Halogen Lights
- Dishwasher-Safe Stainless Steel Filters
- Convertible<sup>1</sup> Exhaust Duct

<sup>1</sup>Ventilation is convertible to be either ducted outside, or recirculated inside requiring no ducting. (Recirculated option requires optional duct-free kit.)



### 30" Built-In Microwave Oven with Drop-Down Door

EMBD3010AS

- Sleek design with glass touch controls
- Convection Cooking
- Sensor Cook Function
- Multi-Stage Cooking
- Preheat/Keep Warm Mode
- Combi Cooking combines the speed of a microwave with the browning and crisping power of convection
- Premium LED Lighting



### 24" Dishwasher

EDSH4944AS

- Get a Sparkling Clean with the LuxCare® Wash Arm
- Perfect Dry® System Gets Dishes Dry the First Time
- 30-Minute Clean Cycle
- Third-Level Rack
- Target Wash Zones
- Convenient LED Floor Beam Indicators
- National Sanitation Foundation® Certified
- Clean Dishes of All Sizes
- Quiet Operation with Luxury-Quiet System

## Electrolux Rangetop Package 2

4540-EF / 4540-FF



### 30" Connected Wall Oven with Air Sous Vide

ECWS3012AS

- Exclusive Air Sous Vide locks in moisture and preserves natural flavors to provide juicy results
- Steam Cooking enhances the natural flavor of foods- from steaks to breads- by creating a crisp golden crust and juicy, flavorful inside
- Electrolux Connect Technology allows for setting, preheating, and monitoring cook times remotely, all from an app



### 36" Gas Rangetop

ECCG3672AS

- Striking Design features sturdy LED backlit knobs, cast-iron grates, and brass accents
- Two Dual Brass Power Burners allow for accurate, efficient temperature control whether boiling or simmering
- Six Flexible Dual Burners allow for cooking multiple dishes with ease



### 36" Hands-Free Hood with Responsive Sensors

ECVW3662AS

- Responsive Sensor
- Perimeter Venting
- Sleek Design
- Premium LED Lighting
- Quieter fan operation for powerful performance with less noise



### 30" Built-In Microwave Oven with Drop-Down Door

EMBD3010AS

- Sleek design with glass touch controls
- Convection Cooking
- Sensor Cook Function
- Multi-Stage Cooking
- Preheat/Keep Warm Mode
- Combi Cooking combines the speed of a microwave with the browning and crisping power of convection
- Premium LED Lighting



### 24" Dishwasher

EDSH4944AS

- Get a Sparkling Clean with the LuxCare® Wash Arm
- Perfect Dry® System Gets Dishes Dry the First Time
- 30-Minute Clean Cycle
- Third-Level Rack
- Target Wash Zones
- Convenient LED Floor Beam Indicators
- National Sanitation Foundation® Certified
- Clean Dishes of All Sizes
- Quiet Operation with Luxury-Quiet System



## Electrolux Rangetop Package 3

4540-EG / 4540-FG



### 30" Connected Wall Oven with Air Sous Vide

ECWS3012AS

- Exclusive Air Sous Vide locks in moisture and preserves natural flavors to provide juicy results
- Steam Cooking enhances the natural flavor of foods- from steaks to breads- by creating a crisp golden crust and juicy, flavorful inside
- Electrolux Connect Technology allows for setting, preheating, and monitoring cook times remotely, all from an app



### 36" Gas Rangetop

ECCG3672AS

- Striking Design features sturdy LED backlit knobs, cast-iron grates, and brass accents
- Two Dual Brass Power Burners allow for accurate, efficient temperature control whether boiling or simmering
- Six Flexible Dual Burners allow for cooking multiple dishes with ease



### 42" Wooden Timberlake Hood



### 30" Built-In Microwave Oven with Drop-Down Door

EMBD3010AS

- Sleek design with glass touch controls
- Convection Cooking
- Sensor Cook Function
- Multi-Stage Cooking
- Preheat/Keep Warm Mode
- Combi Cooking combines the speed of a microwave with the browning and crisping power of convection
- Premium LED Lighting



### 24" Dishwasher

EDSH4944AS

- Get a Sparkling Clean with the LuxCare® Wash Arm
- Perfect Dry® System Gets Dishes Dry the First Time
- 30-Minute Clean Cycle
- Third-Level Rack
- Target Wash Zones
- Convenient LED Floor Beam Indicators
- National Sanitation Foundation® Certified
- Clean Dishes of All Sizes
- Quiet Operation with Luxury-Quiet System

## Electrolux Rangetop Package 5

4540-TI / 4540-TU



### 30" Connected Wall Oven with Air Sous Vide

ECWS3012AS

- Exclusive Air Sous Vide locks in moisture and preserves natural flavors to provide juicy results
- Steam Cooking enhances the natural flavor of foods- from steaks to breads- by creating a crisp golden crust and juicy, flavorful inside
- Electrolux Connect Technology allows for setting, preheating, and monitoring cook times remotely, all from an app



### 36" Gas Rangetop

ECCG3672AS

- Striking Design features sturdy LED backlit knobs, cast-iron grates, and brass accents
- Two Dual Brass Power Burners allow for accurate, efficient temperature control whether boiling or simmering
- Six Flexible Dual Burners allow for cooking multiple dishes with ease



### 42" Wooden Shiplap Hood



### 30" Built-In Microwave Oven with Drop-Down Door

EMBD3010AS

- Sleek design with glass touch controls
- Convection Cooking
- Sensor Cook Function
- Multi-Stage Cooking
- Preheat/Keep Warm Mode
- Combi Cooking combines the speed of a microwave with the browning and crisping power of convection
- Premium LED Lighting



### 24" Dishwasher

EDSH4944AS

- Get a Sparkling Clean with the LuxCare® Wash Arm
- Perfect Dry® System Gets Dishes Dry the First Time
- 30-Minute Clean Cycle
- Third-Level Rack
- Target Wash Zones
- Convenient LED Floor Beam Indicators
- National Sanitation Foundation® Certified
- Clean Dishes of All Sizes
- Quiet Operation with Luxury-Quiet System

## Electrolux Rangetop Package 4

4540-EH / 4540-FH



### 30" Connected Wall Oven with Air Sous Vide

ECWS3012AS

- Exclusive Air Sous Vide locks in moisture and preserves natural flavors to provide juicy results
- Steam Cooking enhances the natural flavor of foods- from steaks to breads- by creating a crisp golden crust and juicy, flavorful inside
- Electrolux Connect Technology allows for setting, preheating, and monitoring cook times remotely, all from an app



### 36" Gas Rangetop

ECCG3672AS

- Striking Design features sturdy LED backlit knobs, cast-iron grates, and brass accents
- Two Dual Brass Power Burners allow for accurate, efficient temperature control whether boiling or simmering
- Six Flexible Dual Burners allow for cooking multiple dishes with ease

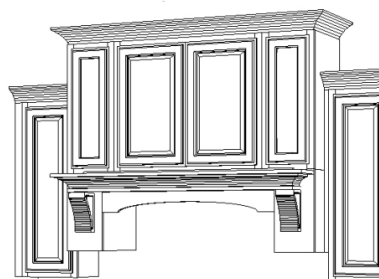

### 62" Wooden Shaker Style Hood



### 30" Built-In Microwave Oven with Drop-Down Door

EMBD3010AS

- Sleek design with glass touch controls
- Convection Cooking
- Sensor Cook Function
- Multi-Stage Cooking
- Preheat/Keep Warm Mode
- Combi Cooking combines the speed of a microwave with the browning and crisping power of convection
- Premium LED Lighting



### 24" Dishwasher

EDSH4944AS

- Get a Sparkling Clean with the LuxCare® Wash Arm
- Perfect Dry® System Gets Dishes Dry the First Time
- 30-Minute Clean Cycle
- Third-Level Rack
- Target Wash Zones
- Convenient LED Floor Beam Indicators
- National Sanitation Foundation® Certified
- Clean Dishes of All Sizes
- Quiet Operation with Luxury-Quiet System

## Electrolux Dual-Fuel Package 1

4540-EI / 4540-FI



### 30" Connected Wall Oven with Air Sous Vide

ECWS3012AS

- Exclusive Air Sous Vide locks in moisture and preserves natural flavors to provide juicy results
- Steam Cooking enhances the natural flavor of foods- from steaks to breads- by creating a crisp golden crust and juicy, flavorful inside
- Electrolux Connect Technology allows for setting, preheating, and monitoring cook times remotely, all from an app



### 36" Dual-Fuel Freestanding Range

ECFD3668AS

- Create the perfect soufflé in the oven and precisely sear meats on the cooktop with Dual Fuel, the ideal combination of a gas cooktop and electric oven for delicious results
- Achieve accurate, efficient temperature control - whether you need a roaring boil or a bare simmer - with Two Dual Brass Power Burners
- Create specialty foods like crepes and paninis with the Integrated Griddle
- Six Flexible Dual Burners allow you to cook multiple dishes at once
- True Convection uses three heating elements and a fan for even cooking results



### 36" Glass Canopy Wall-Mount Hood

FHWC3660LS

- 400 CFMs
- Electronic Push Button Controls
- Centrifugal Fan
- Vertical Air Discharge
- 3 Fan Speeds
- Dual Halogen Lights
- Dishwasher-Safe Stainless Steel Filters
- Convertible<sup>1</sup> Exhaust Duct

<sup>1</sup> Ventilation is convertible to be either ducted outside, or recirculated inside requiring no ducting. (Recirculated option requires optional duct-free kit.)



### 30" Built-In Microwave Oven with Drop-Down Door

EMBD3010AS

- Sleek design with glass touch controls
- Convection Cooking
- Sensor Cook Function
- Multi-Stage Cooking
- Preheat/Keep Warm Mode
- Combi Cooking combines the speed of a microwave with the browning and crisping power of convection
- Premium LED Lighting



### 24" Dishwasher

EDSH4944AS

- Get a Sparkling Clean with the LuxCare® Wash Arm
- Perfect Dry® System Gets Dishes Dry the First Time
- 30-Minute Clean Cycle
- Third-Level Rack
- Target Wash Zones
- Convenient LED Floor Beam Indicators
- National Sanitation Foundation® Certified
- Clean Dishes of All Sizes
- Quiet Operation with Luxury-Quiet System

## Electrolux Dual-Fuel Package 2

4540-EJ / 4540-FJ



### 30" Connected Wall Oven with Air Sous Vide

ECWS3012AS

- Exclusive Air Sous Vide locks in moisture and preserves natural flavors to provide juicy results
- Steam Cooking enhances the natural flavor of foods- from steaks to breads- by creating a crisp golden crust and juicy, flavorful inside
- Electrolux Connect Technology allows for setting, preheating, and monitoring cook times remotely, all from an app



### 36" Dual-Fuel Freestanding Range

ECFD3668AS

- Create the perfect soufflé in the oven and precisely sear meats on the cooktop with Dual Fuel, the ideal combination of a gas cooktop and electric oven for delicious results
- Achieve accurate, efficient temperature control - whether you need a roaring boil or a bare simmer - with Two Dual Brass Power Burners
- Create specialty foods like crepes and paninis with the Integrated Griddle
- Six Flexible Dual Burners allow you to cook multiple dishes at once
- True Convection uses three heating elements and a fan for even cooking results



### 36" Hands- Free Hood with Responsive Sensors

ECVW3662AS

- Responsive Sensor
- Perimeter Venting
- Sleek Design
- Premium LED Lighting
- Quieter fan operation for powerful performance with less noise



### 30" Built-In Microwave Oven with Drop-Down Door

EMBD3010AS

- Sleek design with glass touch controls
- Convection Cooking
- Sensor Cook Function
- Multi-Stage Cooking
- Preheat/Keep Warm Mode
- Combi Cooking combines the speed of a microwave with the browning and crisping power of convection
- Premium LED Lighting



### 24" Dishwasher

EDSH4944AS

- Get a Sparkling Clean with the LuxCare® Wash Arm
- Perfect Dry® System Gets Dishes Dry the First Time
- 30-Minute Clean Cycle
- Third-Level Rack
- Target Wash Zones
- Convenient LED Floor Beam Indicators
- National Sanitation Foundation® Certified
- Clean Dishes of All Sizes
- Quiet Operation with Luxury-Quiet System



## Electrolux Dual-Fuel Package 3

4540-EK / 4540-FK



### 30" Connected Wall Oven with Air Sous Vide

ECWS3012AS

- Exclusive Air Sous Vide locks in moisture and preserves natural flavors to provide juicy results
- Steam Cooking enhances the natural flavor of foods- from steaks to breads- by creating a crisp golden crust and juicy, flavorful inside
- Electrolux Connect Technology allows for setting, preheating, and monitoring cook times remotely, all from an app



### 36" Dual-Fuel Freestanding Range

ECFD3668AS

- Create the perfect soufflé in the oven and precisely sear meats on the cooktop with Dual Fuel, the ideal combination of a gas cooktop and electric oven for delicious results
- Achieve accurate, efficient temperature control - whether you need a roaring boil or a bare simmer - with Two Dual Brass Power Burners
- Create specialty foods like crepes and paninis with the Integrated Griddle
- Six Flexible Dual Burners allow you to cook multiple dishes at once
- True Convection uses three heating elements and a fan for even cooking results



### 42" Wooden Timberlake Hood



### 30" Built-In Microwave Oven with Drop-Down Door

EMBD3010AS

- Sleek design with glass touch controls
- Convection Cooking
- Sensor Cook Function
- Multi-Stage Cooking
- Preheat/Keep Warm Mode
- Combi Cooking combines the speed of a microwave with the browning and crisping power of convection
- Premium LED Lighting



### 24" Dishwasher

EDSH4944AS

- Get a Sparkling Clean with the LuxCare® Wash Arm
- Perfect Dry® System Gets Dishes Dry the First Time
- 30-Minute Clean Cycle
- Third-Level Rack
- Target Wash Zones
- Convenient LED Floor Beam Indicators
- National Sanitation Foundation® Certified
- Clean Dishes of All Sizes
- Quiet Operation with Luxury-Quiet System

## Electrolux Dual-Fuel Package 5

4540-TJ / 4540-TV



### 30" Connected Wall Oven with Air Sous Vide

ECWS3012AS

- Exclusive Air Sous Vide locks in moisture and preserves natural flavors to provide juicy results
- Steam Cooking enhances the natural flavor of foods- from steaks to breads- by creating a crisp golden crust and juicy, flavorful inside
- Electrolux Connect Technology allows for setting, preheating, and monitoring cook times remotely, all from an app



### 36" Dual-Fuel Freestanding Range

ECFD3668AS

- Create the perfect soufflé in the oven and precisely sear meats on the cooktop with Dual Fuel, the ideal combination of a gas cooktop and electric oven for delicious results
- Achieve accurate, efficient temperature control - whether you need a roaring boil or a bare simmer - with Two Dual Brass Power Burners
- Create specialty foods like crepes and paninis with the Integrated Griddle
- Six Flexible Dual Burners allow you to cook multiple dishes at once
- True Convection uses three heating elements and a fan for even cooking results



### 42" Wooden Shiplap Hood



### 30" Built-In Microwave Oven with Drop-Down Door

EMBD3010AS

- Sleek design with glass touch controls
- Convection Cooking
- Sensor Cook Function
- Multi-Stage Cooking
- Preheat/Keep Warm Mode
- Combi Cooking combines the speed of a microwave with the browning and crisping power of convection
- Premium LED Lighting



### 24" Dishwasher

EDSH4944AS

- Get a Sparkling Clean with the LuxCare® Wash Arm
- Perfect Dry® System Gets Dishes Dry the First Time
- 30-Minute Clean Cycle
- Third-Level Rack
- Target Wash Zones
- Convenient LED Floor Beam Indicators
- National Sanitation Foundation® Certified
- Clean Dishes of All Sizes
- Quiet Operation with Luxury-Quiet System

## Electrolux Dual-Fuel Package 4

4540-EL / 4540-FL



### 30" Connected Wall Oven with Air Sous Vide

ECWS3012AS

- Exclusive Air Sous Vide locks in moisture and preserves natural flavors to provide juicy results
- Steam Cooking enhances the natural flavor of foods- from steaks to breads- by creating a crisp golden crust and juicy, flavorful inside
- Electrolux Connect Technology allows for setting, preheating, and monitoring cook times remotely, all from an app



### 36" Dual-Fuel Freestanding Range

ECFD3668AS

- Create the perfect soufflé in the oven and precisely sear meats on the cooktop with Dual Fuel, the ideal combination of a gas cooktop and electric oven for delicious results
- Achieve accurate, efficient temperature control - whether you need a roaring boil or a bare simmer - with Two Dual Brass Power Burners
- Create specialty foods like crepes and paninis with the Integrated Griddle
- Six Flexible Dual Burners allow you to cook multiple dishes at once
- True Convection uses three heating elements and a fan for even cooking results

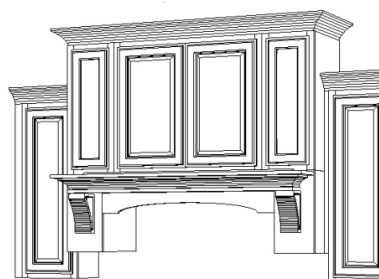

### 62" Wooden Shaker Style Hood



### 30" Built-In Microwave Oven with Drop-Down Door

EMBD3010AS

- Sleek design with glass touch controls
- Convection Cooking
- Sensor Cook Function
- Multi-Stage Cooking
- Preheat/Keep Warm Mode
- Combi Cooking combines the speed of a microwave with the browning and crisping power of convection
- Premium LED Lighting



### 24" Dishwasher

EDSH4944AS

- Get a Sparkling Clean with the LuxCare® Wash Arm
- Perfect Dry® System Gets Dishes Dry the First Time
- 30-Minute Clean Cycle
- Third-Level Rack
- Target Wash Zones
- Convenient LED Floor Beam Indicators
- National Sanitation Foundation® Certified
- Clean Dishes of All Sizes
- Quiet Operation with Luxury-Quiet System

## Electrolux Double Oven Package 1

4540-EM / 4540-FM



### 30" Connected Double Wall Oven with Exclusive Air Sous Vide ECWD3012AS

- Exclusive Air Sous Vide locks in moisture and preserves natural flavors to provide juicy results
- Steam Cooking enhances the natural flavor of foods- from steaks to breads- by creating a crisp golden crust and juicy, flavorful inside
- Electrolux Connect Technology allows for setting, preheating, and monitoring cook times remotely, all from an app



### 36" Gas Cooktop ECCG3668AS

- Striking Design features sturdy LED backlit knobs, cast-iron grates, and brass accents
- High Power Brass Burner allows for accurate, efficient temperature control whether boiling or simmering
- Deep-Well Design provides an easy cleanup



### 36" Glass Canopy Wall-Mount Hood FHCW3660LS

- 400 CFMs
- Electronic Push Button Controls
- Centrifugal Fan
- Vertical Air Discharge
- 3 Fan Speeds
- Dual Halogen Lights
- Dishwasher-Safe Stainless Steel Filters
- Convertible<sup>1</sup> Exhaust Duct

<sup>1</sup> Ventilation is convertible to be either ducted outside, or recirculated inside requiring no ducting. (Recirculated option requires optional duct-free kit.)



### 30" Built-In Microwave Oven with Drop-Down Door EMBD3010AS

- Sleek design with glass touch controls
- Convection Cooking
- Sensor Cook Function
- Multi-Stage Cooking
- Preheat/Keep Warm Mode
- Combi Cooking combines the speed of a microwave with the browning and crisping power of convection
- Premium LED Lighting



### 24" Dishwasher EDSH4944AS

- Get a Sparkling Clean with the LuxCare® Wash Arm
- Perfect Dry® System Gets Dishes Dry the First Time
- 30-Minute Clean Cycle
- Third-Level Rack
- Target Wash Zones
- Convenient LED Floor Beam Indicators
- National Sanitation Foundation® Certified
- Clean Dishes of All Sizes
- Quiet Operation with Luxury-Quiet System

## Electrolux Double Oven Package 2

4540-EN / 4540-FN



### 30" Connected Double Wall Oven with Exclusive Air Sous Vide

ECWD3012AS

- Exclusive Air Sous Vide locks in moisture and preserves natural flavors to provide juicy results
- Steam Cooking enhances the natural flavor of foods- from steaks to breads- by creating a crisp golden crust and juicy, flavorful inside
- Electrolux Connect Technology allows for setting, preheating, and monitoring cook times remotely, all from an app



### 36" Gas Cooktop

ECCG3668AS

- Striking Design features sturdy LED backlit knobs, cast-iron grates, and brass accents
- High Power Brass Burner allows for accurate, efficient temperature control whether boiling or simmering
- Deep-Well Design provides an easy cleanup



### 36" Hands- Free Hood with Responsive Sensors

ECVW3662AS

- Responsive Sensor
- Perimeter Venting
- Sleek Design
- Premium LED Lighting
- Quieter fan operation for powerful performance with less noise



### 30" Built-In Microwave Oven with Drop-Down Door

EMBD3010AS

- Sleek design with glass touch controls
- Convection Cooking
- Sensor Cook Function
- Multi-Stage Cooking
- Preheat/Keep Warm Mode
- Combi Cooking combines the speed of a microwave with the browning and crisping power of convection
- Premium LED Lighting



### 24" Dishwasher

EDSH4944AS

- Get a Sparkling Clean with the LuxCare® Wash Arm
- Perfect Dry® System Gets Dishes Dry the First Time
- 30-Minute Clean Cycle
- Third-Level Rack
- Target Wash Zones
- Convenient LED Floor Beam Indicators
- National Sanitation Foundation® Certified
- Clean Dishes of All Sizes
- Quiet Operation with Luxury-Quiet System



## Electrolux Double Oven Package 3

4540-EO / 4540-FO



### 30" Connected Double Wall Oven with Exclusive Air Sous Vide

ECWD3012AS

- Exclusive Air Sous Vide locks in moisture and preserves natural flavors to provide juicy results
- Steam Cooking enhances the natural flavor of foods- from steaks to breads- by creating a crisp golden crust and juicy, flavorful inside
- Electrolux Connect Technology allows for setting, preheating, and monitoring cook times remotely, all from an app



### 36" Gas Cooktop

ECCG3668AS

- Striking Design features sturdy LED backlit knobs, cast-iron grates, and brass accents
- High Power Brass Burner allows for accurate, efficient temperature control whether boiling or simmering
- Deep-Well Design provides an easy cleanup



### 42" Wooden Timberlake Hood



### 30" Built-In Microwave Oven with Drop-Down Door

EMBD3010AS

- Sleek design with glass touch controls
- Convection Cooking
- Sensor Cook Function
- Multi-Stage Cooking
- Preheat/Keep Warm Mode
- Combi Cooking combines the speed of a microwave with the browning and crisping power of convection
- Premium LED Lighting



### 24" Dishwasher

EDSH4944AS

- Get a Sparkling Clean with the LuxCare® Wash Arm
- Perfect Dry® System Gets Dishes Dry the First Time
- 30-Minute Clean Cycle
- Third-Level Rack
- Target Wash Zones
- Convenient LED Floor Beam Indicators
- National Sanitation Foundation® Certified
- Clean Dishes of All Sizes
- Quiet Operation with Luxury-Quiet System



## Electrolux Double Oven Package 5

4540-TK / 4540-TW



### 30" Connected Double Wall Oven with Exclusive Air Sous Vide

ECWD3012AS

- Exclusive Air Sous Vide locks in moisture and preserves natural flavors to provide juicy results
- Steam Cooking enhances the natural flavor of foods- from steaks to breads- by creating a crisp golden crust and juicy, flavorful inside
- Electrolux Connect Technology allows for setting, preheating, and monitoring cook times remotely, all from an app



### 36" Gas Cooktop

ECCG3668AS

- Striking Design features sturdy LED backlit knobs, cast-iron grates, and brass accents
- High Power Brass Burner allows for accurate, efficient temperature control whether boiling or simmering
- Deep-Well Design provides an easy cleanup



### 42" Wooden Shiplap Hood



### 30" Built-In Microwave Oven with Drop-Down Door

EMBD3010AS

- Sleek design with glass touch controls
- Convection Cooking
- Sensor Cook Function
- Multi-Stage Cooking
- Preheat/Keep Warm Mode
- Combi Cooking combines the speed of a microwave with the browning and crisping power of convection
- Premium LED Lighting



### 24" Dishwasher

EDSH4944AS

- Get a Sparkling Clean with the LuxCare® Wash Arm
- Perfect Dry® System Gets Dishes Dry the First Time
- 30-Minute Clean Cycle
- Third-Level Rack
- Target Wash Zones
- Convenient LED Floor Beam Indicators
- National Sanitation Foundation® Certified
- Clean Dishes of All Sizes
- Quiet Operation with Luxury-Quiet System

## Electrolux Double Oven Package 4

4540-EP / 4540-FP



### 30" Connected Double Wall Oven with Exclusive Air Sous Vide

ECWD3012AS

- Exclusive Air Sous Vide locks in moisture and preserves natural flavors to provide juicy results
- Steam Cooking enhances the natural flavor of foods- from steaks to breads- by creating a crisp golden crust and juicy, flavorful inside
- Electrolux Connect Technology allows for setting, preheating, and monitoring cook times remotely, all from an app



### 36" Gas Cooktop

ECCG3668AS

- Striking Design features sturdy LED backlit knobs, cast-iron grates, and brass accents
- High Power Brass Burner allows for accurate, efficient temperature control whether boiling or simmering
- Deep-Well Design provides an easy cleanup

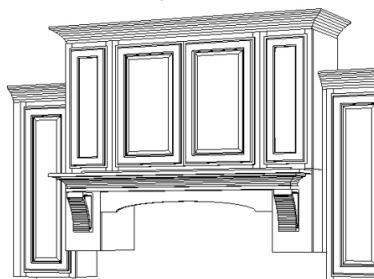

### 62" Wooden Shaker Style Hood



### 30" Built-In Microwave Oven with Drop-Down Door

EMBD3010AS

- Sleek design with glass touch controls
- Convection Cooking
- Sensor Cook Function
- Multi-Stage Cooking
- Preheat/Keep Warm Mode
- Combi Cooking combines the speed of a microwave with the browning and crisping power of convection
- Premium LED Lighting



### 24" Dishwasher

EDSH4944AS

- Get a Sparkling Clean with the LuxCare® Wash Arm
- Perfect Dry® System Gets Dishes Dry the First Time
- 30-Minute Clean Cycle
- Third-Level Rack
- Target Wash Zones
- Convenient LED Floor Beam Indicators
- National Sanitation Foundation® Certified
- Clean Dishes of All Sizes
- Quiet Operation with Luxury-Quiet System

## Electrolux Double Oven Rangetop Package 1

4540-EQ / 4540-FQ



### 30" Connected Double Wall Oven with Exclusive Air Sous Vide ECWD3012AS

- Exclusive Air Sous Vide locks in moisture and preserves natural flavors to provide juicy results
- Steam Cooking enhances the natural flavor of foods- from steaks to breads- by creating a crisp golden crust and juicy, flavorful inside
- Electrolux Connect Technology allows for setting, preheating, and monitoring cook times remotely, all from an app



### 36" Gas Rangetop ECCG3672AS

- Striking Design features sturdy LED backlit knobs, cast-iron grates, and brass accents
- Two Dual Brass Power Burners allow for accurate, efficient temperature control whether boiling or simmering
- Six Flexible Dual Burners allow for cooking multiple dishes with ease



### 36" Glass Canopy Wall-Mount Hood FHWC3660LS

- 400 CFMs
- Electronic Push Button Controls
- Centrifugal Fan
- Vertical Air Discharge
- 3 Fan Speeds
- Dual Halogen Lights
- Dishwasher-Safe Stainless Steel Filters
- Convertible<sup>1</sup> Exhaust Duct

<sup>1</sup> Ventilation is convertible to be either ducted outside, or recirculated inside requiring no ducting. (Recirculated option requires optional duct-free kit.)



### 30" Built-In Microwave Oven with Drop-Down Door EMBD3010AS

- Sleek design with glass touch controls
- Convection Cooking
- Sensor Cook Function
- Multi-Stage Cooking
- Preheat/Keep Warm Mode
- Combi Cooking combines the speed of a microwave with the browning and crisping power of convection
- Premium LED Lighting



### 24" Dishwasher EDSH4944AS

- Get a Sparkling Clean with the LuxCare® Wash Arm
- Perfect Dry® System Gets Dishes Dry the First Time
- 30-Minute Clean Cycle
- Third-Level Rack
- Target Wash Zones
- Convenient LED Floor Beam Indicators
- National Sanitation Foundation® Certified
- Clean Dishes of All Sizes
- Quiet Operation with Luxury-Quiet System

## Electrolux Double Oven Rangetop Package 2

4540-ER / 4540-FR



### 30" Connected Double Wall Oven with Exclusive Air Sous Vide ECWD3012AS

- Exclusive Air Sous Vide locks in moisture and preserves natural flavors to provide juicy results
- Steam Cooking enhances the natural flavor of foods- from steaks to breads- by creating a crisp golden crust and juicy, flavorful inside
- Electrolux Connect Technology allows for setting, preheating, and monitoring cook times remotely, all from an app



### 36" Gas Rangetop ECCG3672AS

- Striking Design features sturdy LED backlit knobs, cast-iron grates, and brass accents
- Two Dual Brass Power Burners allow for accurate, efficient temperature control whether boiling or simmering
- Six Flexible Dual Burners allow for cooking multiple dishes with ease



### 36" Hands- Free Hood with Responsive Sensors ECVW3662AS

- Responsive Sensor
- Perimeter Venting
- Sleek Design
- Premium LED Lighting
- Quieter fan operation for powerful performance with less noise



### 30" Built-In Microwave Oven with Drop-Down Door EMBD3010AS

- Sleek design with glass touch controls
- Convection Cooking
- Sensor Cook Function
- Multi-Stage Cooking
- Preheat/Keep Warm Mode
- Combi Cooking combines the speed of a microwave with the browning and crisping power of convection
- Premium LED Lighting



### 24" Dishwasher EDSH4944AS

- Get a Sparkling Clean with the LuxCare® Wash Arm
- Perfect Dry® System Gets Dishes Dry the First Time
- 30-Minute Clean Cycle
- Third-Level Rack
- Target Wash Zones
- Convenient LED Floor Beam Indicators
- National Sanitation Foundation® Certified
- Clean Dishes of All Sizes
- Quiet Operation with Luxury-Quiet System





## Electrolux Double Oven Rangetop Package 3

4540-ES / 4540-FS



### 30" Connected Double Wall Oven with Exclusive Air Sous Vide ECWD3012AS

- Exclusive Air Sous Vide locks in moisture and preserves natural flavors to provide juicy results
- Steam Cooking enhances the natural flavor of foods- from steaks to breads- by creating a crisp golden crust and juicy, flavorful inside
- Electrolux Connect Technology allows for setting, preheating, and monitoring cook times remotely, all from an app



### 36" Gas Rangetop ECCG3672AS

- Striking Design features sturdy LED backlit knobs, cast-iron grates, and brass accents
- Two Dual Brass Power Burners allow for accurate, efficient temperature control whether boiling or simmering
- Six Flexible Dual Burners allow for cooking multiple dishes with ease



### 42" Wooden Timberlake Hood



### 30" Built-In Microwave Oven with Drop-Down Door

EMBD3010AS

- Sleek design with glass touch controls
- Convection Cooking
- Sensor Cook Function
- Multi-Stage Cooking
- Preheat/Keep Warm Mode
- Combi Cooking combines the speed of a microwave with the browning and crisping power of convection
- Premium LED Lighting



### 24" Dishwasher EDSH4944AS

- Get a Sparkling Clean with the LuxCare® Wash Arm
- Perfect Dry® System Gets Dishes Dry the First Time
- 30-Minute Clean Cycle
- Third-Level Rack
- Target Wash Zones
- Convenient LED Floor Beam Indicators
- National Sanitation Foundation® Certified
- Clean Dishes of All Sizes
- Quiet Operation with Luxury-Quiet System



## Electrolux Double Oven Rangetop Package 5

4540-TL / 4540-TX



### 30" Connected Double Wall Oven with Exclusive Air Sous Vide ECWD3012AS

- Exclusive Air Sous Vide locks in moisture and preserves natural flavors to provide juicy results
- Steam Cooking enhances the natural flavor of foods- from steaks to breads- by creating a crisp golden crust and juicy, flavorful inside
- Electrolux Connect Technology allows for setting, preheating, and monitoring cook times remotely, all from an app



### 36" Gas Rangetop ECCG3672AS

- Striking Design features sturdy LED backlit knobs, cast-iron grates, and brass accents
- Two Dual Brass Power Burners allow for accurate, efficient temperature control whether boiling or simmering
- Six Flexible Dual Burners allow for cooking multiple dishes with ease



### 42" Wooden Shiplap Hood



### 30" Built-In Microwave Oven with Drop-Down Door

EMBD3010AS

- Sleek design with glass touch controls
- Convection Cooking
- Sensor Cook Function
- Multi-Stage Cooking
- Preheat/Keep Warm Mode
- Combi Cooking combines the speed of a microwave with the browning and crisping power of convection
- Premium LED Lighting



### 24" Dishwasher EDSH4944AS

- Get a Sparkling Clean with the LuxCare® Wash Arm
- Perfect Dry® System Gets Dishes Dry the First Time
- 30-Minute Clean Cycle
- Third-Level Rack
- Target Wash Zones
- Convenient LED Floor Beam Indicators
- National Sanitation Foundation® Certified
- Clean Dishes of All Sizes
- Quiet Operation with Luxury-Quiet System



## Electrolux Double Oven Rangetop Package 4

4540-ET / 4540-FT



### 30" Connected Double Wall Oven with Exclusive Air Sous Vide ECWD3012AS

- Exclusive Air Sous Vide locks in moisture and preserves natural flavors to provide juicy results
- Steam Cooking enhances the natural flavor of foods- from steaks to breads- by creating a crisp golden crust and juicy, flavorful inside
- Electrolux Connect Technology allows for setting, preheating, and monitoring cook times remotely, all from an app



### 36" Gas Rangetop ECCG3672AS

- Striking Design features sturdy LED backlit knobs, cast-iron grates, and brass accents
- Two Dual Brass Power Burners allow for accurate, efficient temperature control whether boiling or simmering
- Six Flexible Dual Burners allow for cooking multiple dishes with ease

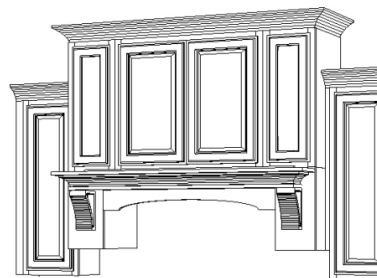

### 62" Wooden Shaker Style Hood



### 30" Built-In Microwave Oven with Drop-Down Door EMBD3010AS

- Sleek design with glass touch controls
- Convection Cooking
- Sensor Cook Function
- Multi-Stage Cooking
- Preheat/Keep Warm Mode
- Combi Cooking combines the speed of a microwave with the browning and crisping power of convection
- Premium LED Lighting



### 24" Dishwasher EDSH4944AS

- Get a Sparkling Clean with the LuxCare® Wash Arm
- Perfect Dry® System Gets Dishes Dry the First Time
- 30-Minute Clean Cycle
- Third-Level Rack
- Target Wash Zones
- Convenient LED Floor Beam Indicators
- National Sanitation Foundation® Certified
- Clean Dishes of All Sizes
- Quiet Operation with Luxury-Quiet System

## Frigidaire Gallery® Refrigerator Options

**FRIGIDAIRE**  
GALLERY



### 25.6 Cu. Ft. 36" Standard Depth Side by Side Refrigerator

GRSS2652AF

- EvenTemp® Cooling System reacts quickly to temperature fluctuations and constantly circulates cold air to keep foods fresh and reduce freezer burn
- Advanced CrispSeal® Plus keeps produce fresh with a seal that blocks out dry air, plus an added filter reduces the gas that causes produce to ripen faster
- SpaceWise® Organization System
- Deli Drawer



### 22.3 Cu. Ft. 36" Counter Depth Side by Side Refrigerator

GRSC2352AF

- CrispSeal® Plus Crisper
- SpaceWise® Organization System
- EvenTemp™ Cooling System
- Multi-Level Bright LED Lighting
- Deli Drawer
- PureAir Ultra® II Air Filter
- PurePour™ Water Filter



### 27.8 Cu. Ft. French Door Refrigerator

GRFS2853AF

- CrispSeal® Plus Crispers with Auto Humidity
- SpaceWise® Organization System
- Adjustable Temp Drawer
- Packed with technologies that reduce food waste and energy consumption
- Large Door Bin Storage
- Auto-Close Doors
- EvenTemp™ Cooling System keeps your food fresh and reduce freezer burn
- Bright LED Lighting

## Black Stainless Refrigerator Options

**FRIGIDAIRE**  
GALLERY

**NEWMARK**  
HOMES



### 25.6 Cu. Ft. 36" Standard Depth Side by Side Refrigerator

GRSS2652AD

- EvenTemp® Cooling System reacts quickly to temperature fluctuations and constantly circulates cold air to keep foods fresh and reduce freezer burn
- Advanced CrispSeal® Plus keeps produce fresh with a seal that blocks out dry air, plus an added filter reduces the gas that causes produce to ripen faster
- SpaceWise® Organization System
- Deli Drawer



### 22.3 Cu. Ft. 36" Counter Depth Side by Side Refrigerator

GRSC2352AD

- CrispSeal® Plus Crisper
- SpaceWise® Organization System
- EvenTemp™ Cooling System
- Multi-Level Bright LED Lighting
- Deli Drawer
- PureAir Ultra® II Air Filter
- PurePour™ Water Filter



### 27.8 Cu. Ft. French Door Refrigerator

GRFS2853AD

- CrispSeal® Plus Crispers with Auto Humidity
- SpaceWise® Organization System
- Adjustable Temp Drawer
- Packed with technologies that reduce food waste and energy consumption
- Large Door Bin Storage
- Auto-Close Doors
- EvenTemp™ Cooling System keeps your food fresh and reduce freezer burn
- Bright LED Lighting



### 22.6 Cu. Ft. Counter-Depth French Door Refrigerator

GRFC2353AD

- CrispSeal® Plus Crispers with Auto Humidity
- SpaceWise® Organization System
- Adjustable Temp Drawer
- Packed with technologies that reduce food waste and energy consumption
- Large Door Bin Storage
- Auto-Close Doors
- EvenTemp™ Cooling System keeps your food fresh and reduce freezer burn
- Bright LED Lighting



## Frigidaire Professional® Refrigerator Options

**FRIGIDAIRE**  
PROFESSIONAL.



### 22.6 Cu. Ft. French Door Counter-Depth Refrigerator

PRFC2383AF

- Multi-level LED Lighting
- 1 Full-Width Deli Drawer
- PureSource Ultra® II Ice & Water Filtration
- PureAir Ultra® II Air Filtration
- 2 Humidity-Controlled CrispSeal™ Crispers
- SpaceWise® Organization System
- SpaceWise® Freezer Organization System
- Effortless® Glide Freezer Drawers
- Dual Ice
- PowerPlus Freeze

## Electrolux Refrigerator Option



### Counter-Depth French Door Refrigerator

ERMC2295AS

- TempAdapt™ Drawer
- Flexible Organization System
- LuxCool™ Plus Cooling System
- TasteLock™ Crisper Drawers with Auto-Humidity Control
- ExtraAccess™ Door
- Auto-Close Doors
- PureAdvantage® Ultra II Air Filter
- PureAdvantage® Water Filter
- Tall Ice and Water Pocket
- Quick Freeze
- Get a Built-In Look with Counter-Depth Design

## Frigidaire® Top Load Laundry Options

# FRIGIDAIRE



### HE Top Load Washer

FFTW4120SW

- 4.1 Cu. Ft Capacity
- 12 Wash Cycles
- 680 RPM Spin Speed
- Agitator Wash System
- 5 Temperature Selections
- Stainless Steel Drum
- Electronic Controls



### Electric Dryer

FFRE4120SW

- 6.7 Cu. Ft Capacity
- 10 Dry Cycles
- 5 Temperature Selections
- 5 Dryness Levels
- Quick Dry Cycle
- Wrinkle Release Option
- Reversible Door
- Stainless Steel Drum

## Electrolux Front Load Laundry Options



### 4.5 Cu. Ft. Front Load Washer

ELFW7537AW

- LuxCare® Plus Wash System offers a thorough clean with even distribution of detergent and additives, improved wash actions, temperature control and smart load sensing
- Pure Rinse™ option rinses cleaner
- 15-Minute Fast Wash
- World's first Adaptive Dispenser™ designed to accept PODS®
- Perfect Steam™ removes tough stains
- Solid Soil level cleans caked on stains
- Remove bacteria with the Sanitize setting
- Remove allergens with our Allergen option

### 8.0 Cu. Ft. Front Load Electric Dryer

ELFE7537AW

- Get a more precise dry with our LuxCare® Dry System
- Instant Refresh cycle revives fabrics without washing
- 15-Minute Fast Dry
- Predictive Dry™ more accurately predicts dry times
- Eco-friendly normal cycle
- Perfect Steam™ option
- Extended Tumble option keeps clothes tangle-free



### 4.5 Cu. Ft. Front Load Washer

ELFW7637AW

- The most effective stain-removing washer with SmartBoost®
- Optic Whites™ cycle keeps whites whiter than bleach
- Pure Rinse™ option
- 15-Minute Fast Wash
- Thorough cleaning with the LuxCare® Plus Wash System
- StainSoak™ option eliminates pre-treat
- Remove bacteria with the Sanitize setting
- Allergen option
- World's first Adaptive Dispenser™ designed to accept PODS®
- Perfect Steam™ removes tough stains
- Solid Soil level cleans caked on stains
- Hand Wash cycle

### 8.0 Cu. Ft. Front Load Electric Dryer

ELFE7637AW

- Balanced Dry™ keeps clothes cooler
- Get a more precise dry with our LuxCare® Dry System
- Instant Refresh cycle revives fabrics without washing
- 15-Minute Fast Dry
- Predictive Dry™ more accurately predicts dry times
- Eco-friendly normal cycle
- Perfect Steam™ option
- Extended Tumble option keeps clothes tangle-free
- LuxCare® Lint Shield
- Air Dry cycle
- Extra Large Capacity
- Fits more rooms with reversible door



### 4.5 Cu. Ft. Front Load Washer

ELFW7637AT

- The most effective stain-removing washer with SmartBoost®
- Optic Whites™ cycle keeps whites whiter than bleach
- Pure Rinse™ option
- 15-Minute Fast Wash
- Thorough cleaning with the LuxCare® Plus Wash System
- StainSoak™ option eliminates pre-treat
- Remove bacteria with the Sanitize setting
- Allergen option
- World's first Adaptive Dispenser™ designed to accept PODS®
- Perfect Steam™ removes tough stains
- Solid Soil level cleans caked on stains
- Hand Wash cycle

### 8.0 Cu. Ft. Front Load Electric Dryer

ELFE7637AT

- Balanced Dry™ keeps clothes cooler
- Get a more precise dry with our LuxCare® Dry System
- Instant Refresh cycle revives fabrics without washing
- 15-Minute Fast Dry
- Predictive Dry™ more accurately predicts dry times
- Eco-friendly normal cycle
- Perfect Steam™ option
- Extended Tumble option keeps clothes tangle-free
- LuxCare® Lint Shield
- Air Dry cycle
- Extra Large Capacity
- Fits more rooms with reversible door

## Frigidaire® Under-Counter Options

# FRIGIDAIRE



### 4.6 Cu. Ft. Beverage Center

FFBC4622QS

- 138 12 oz. Can Capacity
- Freestanding Installation
- Precision Electronic Temperature Control with LED Digital Display
- 1 Temperature Zone Range 33°-50° F
- 3 SpaceWise® Adjustable Glass Shelves
- LED Exhibit Lighting
- Contemporary Top Front-Mounted Handle



### 4.4 Cu. Ft. Wine Cooler

FFWC3822QS

- 38-Bottle Capacity
- Freestanding Installation
- Precision Electronic Temperature Control with LED Digital Display
- 2 Temperature Zone Ranges Top 41°-54° F / Bottom 55°-64° F
- 5 Stained, Slide-Out Wood Racks
- Bright LED Exhibit Lighting
- Contemporary Top Front-Mounted Handle



## Electrolux Under-Counter Options



### 41" Wine Cooler

EI24WC15VS

- 41-Bottle Capacity accommodates any shape or assortment of bottles
- Premium Wide-Slat Walnut Shelving stores bottles without scratching the labels
- Fully extendable shelving
- Perfect Set® Temperature Controls keeps collection chilled at a precise 54°
- Luxury-Design® LED Lighting
- UV-Filtered Glass Door
- Fully Integrated Controls
- Reversible Door



### 5.2 Cubic Feet Beverage Center

EI24BC15VS

- Premium glass shelving and stainless steel trim
- Perfect Set® Temperature Controls chills beverages anywhere from 36° to 50°
- Luxury-Design® LED Lighting
- Integrated Controls
- Frost-Free Performance
- High/Low Temperature and Door Ajar Alert