



# Essential



**ELEVATION 1**



**ELEVATION 2**



**ELEVATION 3**

REV 07/23 (Q45A)



These drawings are conceptual only and are for the convenience of reference. They should not be relied upon as representations, express or implied, of the final detail of the residences. The builder expressly reserves the right to make modifications, revisions, and changes it deems desirable in its sole and absolute discretion. Dimensions and square footages are approximate and may vary with actual construction.



[newmarkhomes.com](http://newmarkhomes.com)

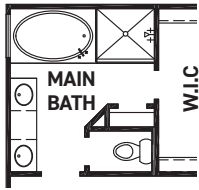

OPT. TUB  
MAIN BATH



OPT. EXTENDED  
COVERED PATIO



OPT. SLIDING  
DOOR @ BREAKFAST

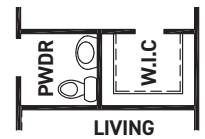
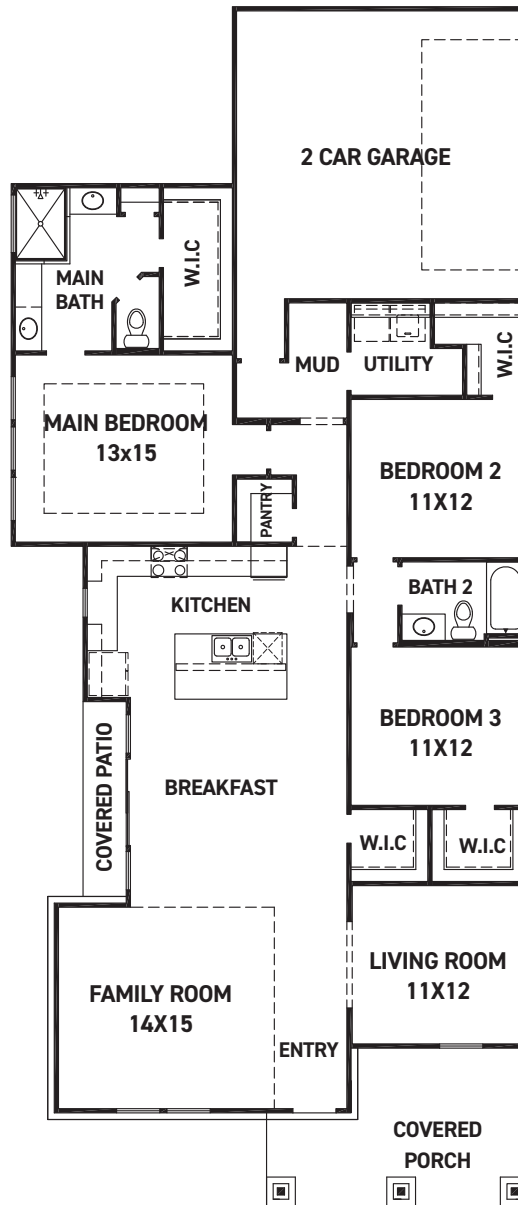

OPT. POWDER  
LIVING

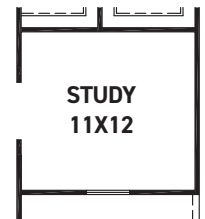

OPT. STUDY  
@ LIVING

## FIRST FLOOR PLAN

### FEATURES:

- 1,904 SQUARE FT.
- 3 BEDROOM
- 2 BATHROOM
- 2 CAR GARAGE

REV 07/23 (Q45A)



These drawings are conceptual only and are for the convenience of reference. They should not be relied upon as representations, express or implied, of the final detail of the residences. The builder expressly reserves the right to make modifications, revisions, and changes it deems desirable in its sole and absolute discretion. Dimensions and square footages are approximate and may vary with actual construction.

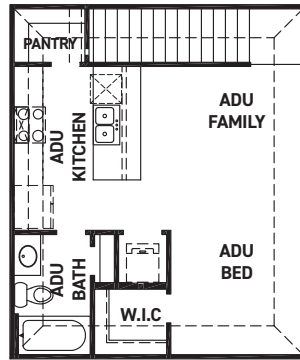
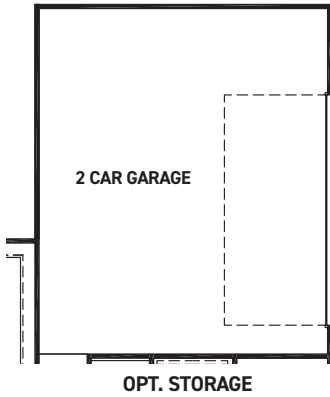

OPT. A.D.U  
+506 SQ. FT.

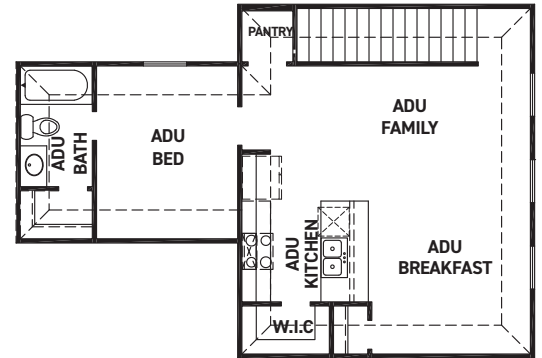

OPT. A.D.U W/ BEDROOM  
+700 SQ. FT.

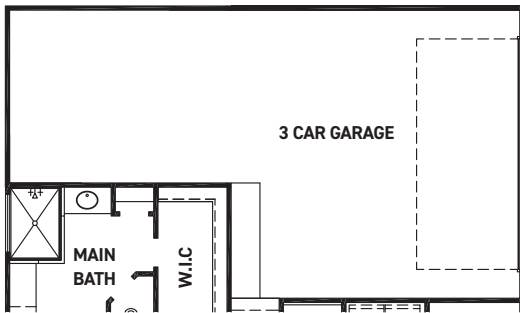

OPT. 3RD BAY

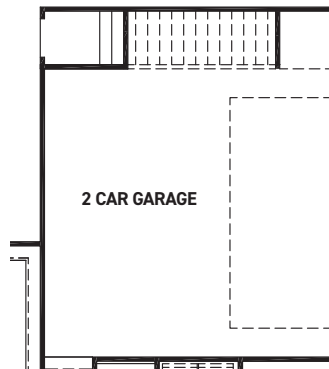

OPT. FIRST FLOOR W/ A.D.U

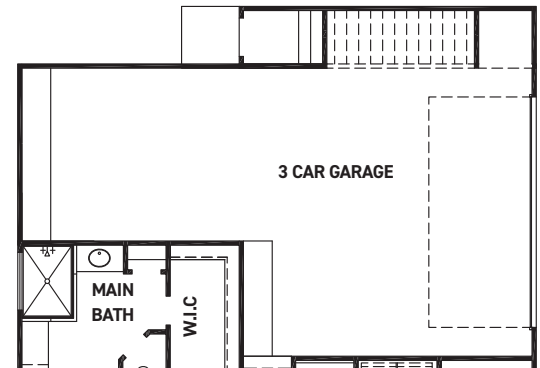

OPT. FIRST FLOOR W/  
A.D.U W/ BEDROOM

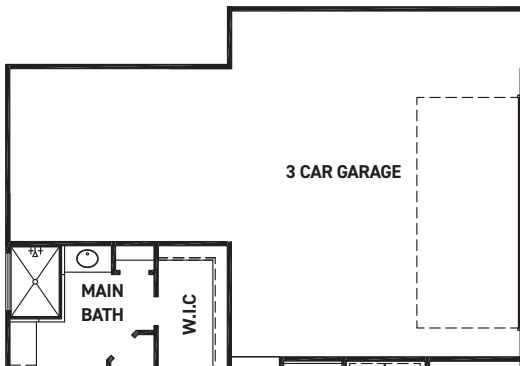

OPT. STORAGE W/ 3RD BAY



# Essential



REV 07/23 (Q45A)



These drawings are conceptual only and are for the convenience of reference. They should not be relied upon as representations, express or implied, of the final detail of the residences. The builder expressly reserves the right to make modifications, revisions, and changes it deems desirable in its sole and absolute discretion. Dimensions and square footages are approximate and may vary with actual construction.



[newmarkhomes.com](http://newmarkhomes.com)